



Weasler®

***AFTERMARKET
PRODUCT GUIDE***

**METRIC DRIVELINES
& COMPONENTS**

METRIC DRIVELINES & COMPONENTS

SAFETY SECTION

WARNING!

- Be certain to disengage PTO shaft and to turn off the tractor before making any operational maintenance inspections or repairs. Keep clear of the machine until all parts have stopped moving.
- NEVER operate an implement with driveline guards missing or in a damaged condition.
- Guards must rotate freely on the yokes.

SAFETY DECALS



PART NO.: 13-10022

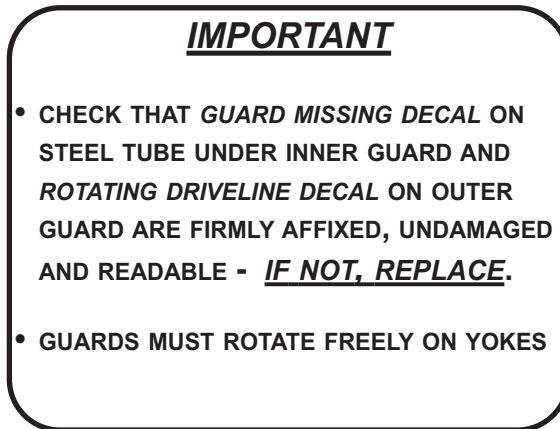

PART NO.: 13-10021

FOR USE ON
IMPLEMENT END
ONLY



ALL CLUTCHES MUST BE USED
ON THE IMPLEMENT END ONLY
Yellow decal is provided on clutch.

SAFETY MANUAL -

The *Agricultural Driveline Manufacturers Association (ADMA)* has printed a Safety Manual for owners and operators of agricultural machinery. Copies can be ordered from Weasler.
PART NO.: 56-15123

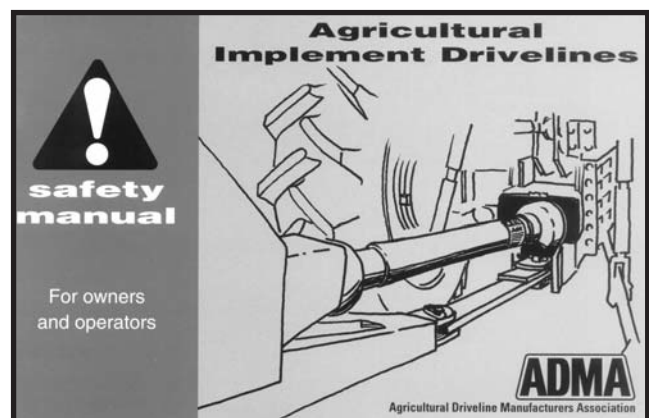

EASY LOCK GUARD SYSTEM

INSTRUCTIONS FOR REMOVAL AND INSTALLATION OF EASY LOCK GUARDS

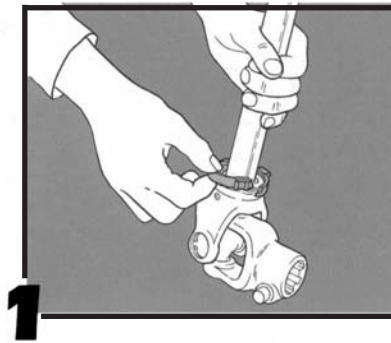
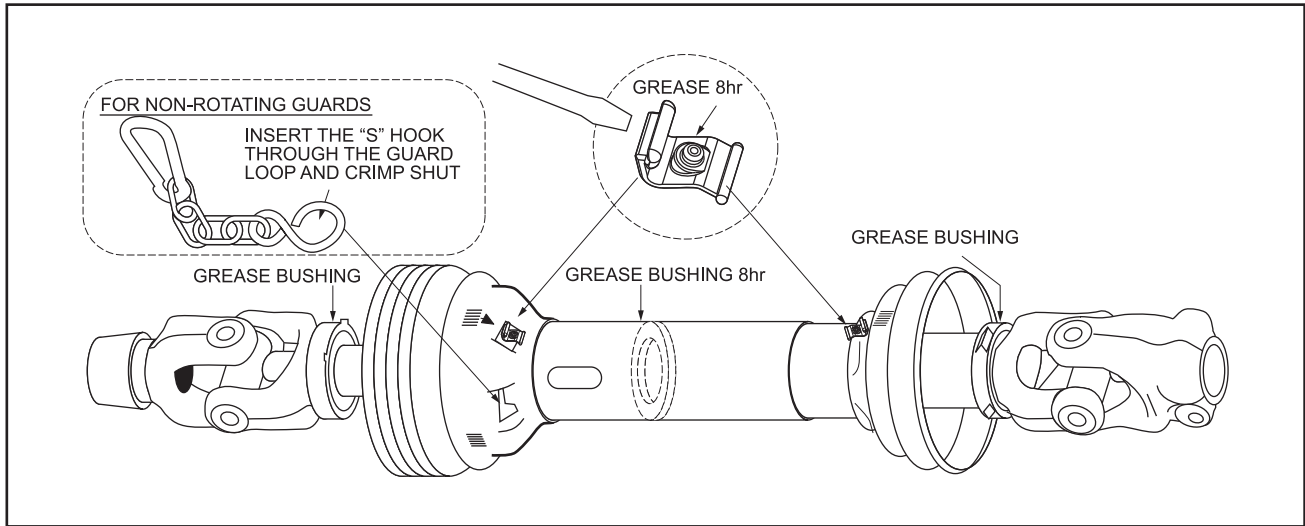

1 Clean and grease bearing raceway before the nylon bearing is placed in the groove. Grease any remaining nylon bearings in guard.

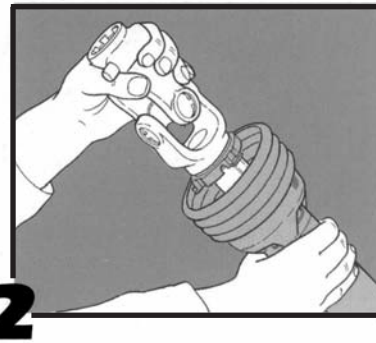

2 Slide guard half over driveline and insert nylon bearing tabs into the openings in the guard.

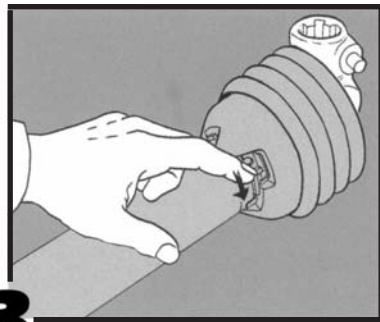

3 Turn the nylon bearing until it engages into the guard.

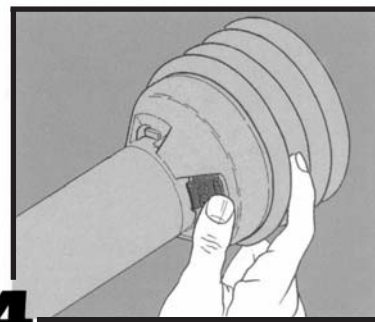

4 Push *Easy Lock* clip into position. The nylon bearing and guard are now secure. **GUARDS MUST ROTATE FREELY ON YOKES.**

5 **TO REMOVE GUARD** - Use screwdriver to release *Easy Lock* clip. Turn the nylon bearings to disengage from the guard and remove guard.

GREASING RECOMMENDATIONS

Be certain to follow greasing instructions as identified below:

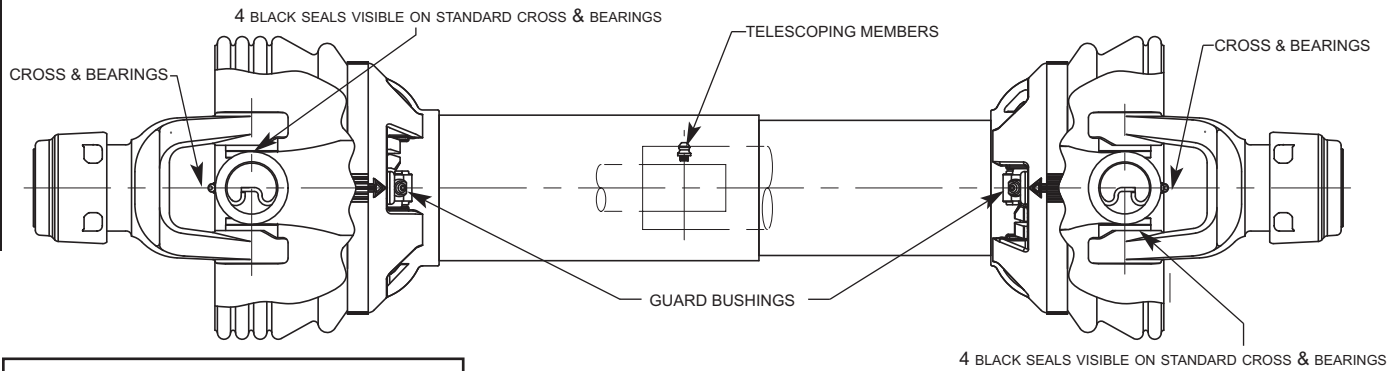

TELESCOPING DRIVELINES

LUBRICATE ALL FITTINGS WITH A GOOD QUALITY LITHIUM SOAP COMPATIBLE E.P. GREASE MEETING THE N.L.G.I. #2 SPECIFICATIONS AND CONTAINING NO MORE THAN 1% MOLYBDENUM DISULFIDE.

AN E.P. GREASE MEETING THE N.L.G.I. #2 SPECIFICATIONS AND CONTAINING 3% MOLYBDENUM DISULFIDE MAY BE SUBSTITUTED IN THE TELESCOPING MEMBERS ONLY.

LOCATION	STANDARD INTERVAL	EXTENDED LUBE INTERVAL	LEVER ACTION PUMPS
CROSS & BEARINGS	*8 HRS.	50 HRS.	2-3
TELESCOPING MEMBERS	8 HRS.	50 HRS.	8-10
CE & NON-ROTATING GUARD BUSHINGS (1000 RPM MAX.)	8 HRS.	50 HRS.	2

ROTATING GUARD BUSHINGS SHOULD BE LUBRICATED UPON REPLACEMENT

*CONSTANT ANGLE APPLICATIONS MAY REQUIRE A LUBE INTERVAL OF 4 HOURS

CAUTION!! REPLACEMENT PARTS ARE NOT LUBRICATED

REPLACEMENT PARTS MUST BE LUBRICATED AT TIME OF ASSEMBLY AND DURING USE PER THE LUBE RECOMMENDATIONS

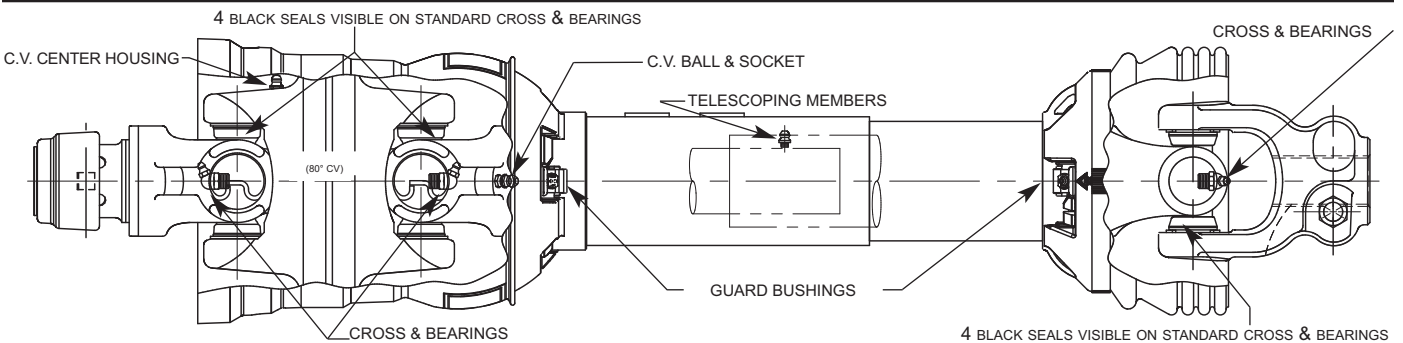

80° CONSTANT VELOCITY DRIVELINES

LUBRICATE ALL FITTINGS WITH A GOOD QUALITY LITHIUM SOAP COMPATIBLE E.P. GREASE MEETING THE N.L.G.I. #2 SPECIFICATIONS AND CONTAINING NO MORE THAN 1% MOLYBDENUM DISULFIDE.

AN E.P. GREASE MEETING THE N.L.G.I. #2 SPECIFICATIONS AND CONTAINING 3% MOLYBDENUM DISULFIDE MAY BE SUBSTITUTED IN THE TELESCOPING MEMBERS ONLY.

LOCATION	STANDARD INTERVAL	EXTENDED LUBE INTERVAL	LEVER ACTION PUMPS
CROSS & BEARINGS	*8 HRS.	50 HRS.	2-3
TELESCOPING MEMBERS	8 HRS.	50 HRS.	8-10
CV BALL & SOCKET	*8 HRS.	50 HRS.	4-6
CV CENTER HOUSING	24 HRS.	50 HRS.	12-15
CE & NON-ROTATING GUARD BUSHINGS (1000 RPM MAX.)	8 HRS.	50 HRS.	2

ROTATING GUARD BUSHINGS SHOULD BE LUBRICATED UPON REPLACEMENT

*CONSTANT ANGLE APPLICATIONS MAY REQUIRE A LUBE INTERVAL OF 4 HOURS

CAUTION!! REPLACEMENT PARTS ARE NOT LUBRICATED

REPLACEMENT PARTS MUST BE LUBRICATED AT TIME OF ASSEMBLY AND DURING USE PER THE LUBE RECOMMENDATIONS

TRANSPARENCY IDENTIFICATION SYSTEM

for Metric Driveline Components
(Stock No. 12008500)

The individual transparency cards will allow the user to easily identify driveline components. Cross and Bearing Kits may be identified by the bearing cup outside diameter and the width of the cross. Yokes may be identified by the hole in the ear and profile. Profile tubes may be identified by the end sections.

How to use the Transparency Identification System:

1. Match the part to be replaced with the corresponding transparency card for identification.
2. Select the proper stock number for the replacement part.

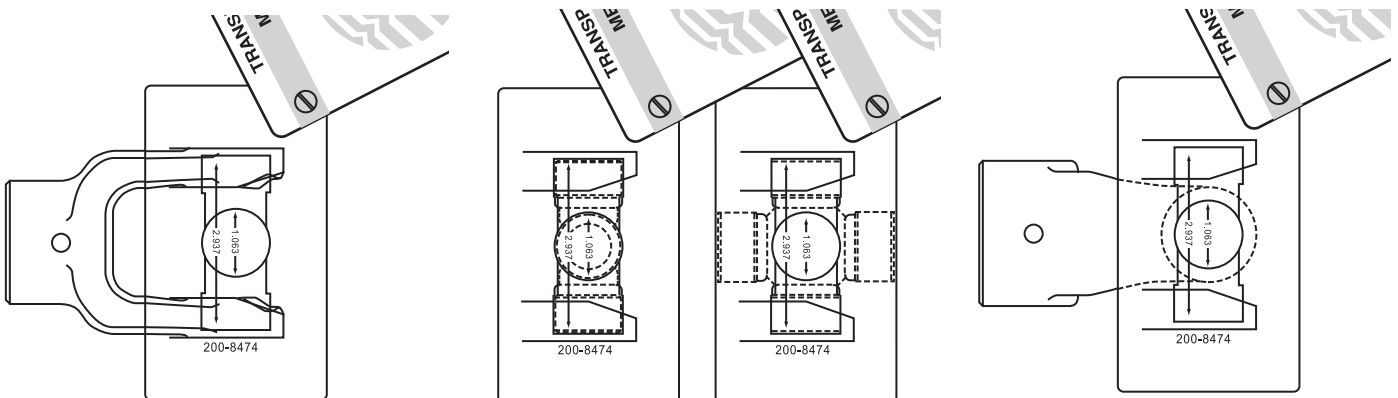
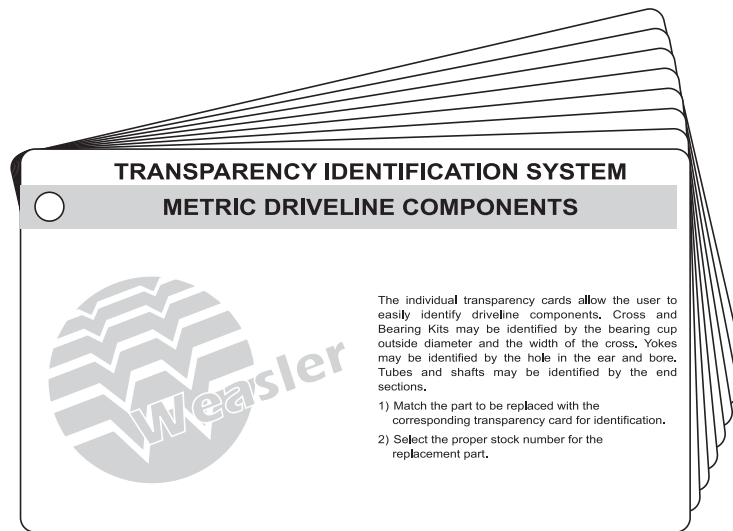

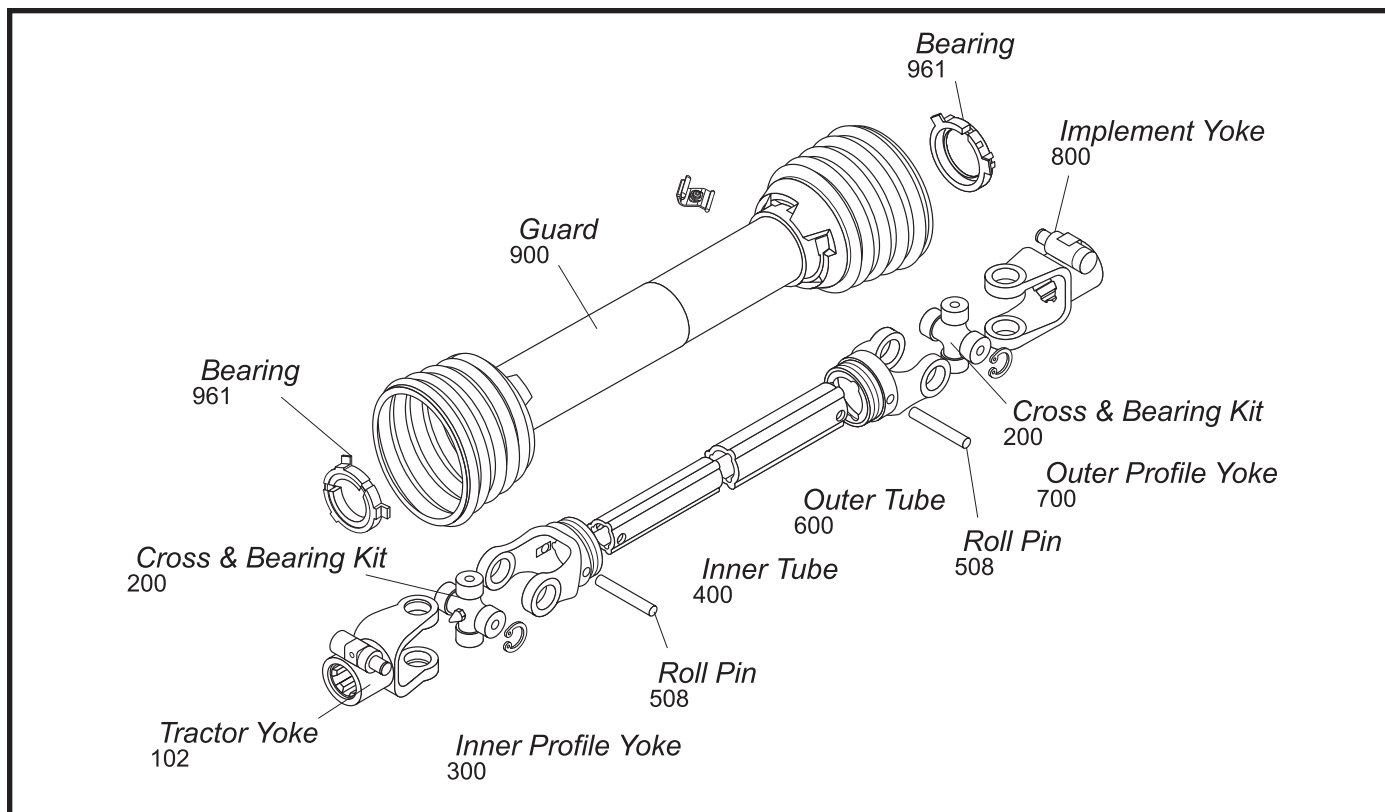

Each series has an exploded view for identification purposes. The drawing illustrates the components in the same sequence as an implement input driveline transmitting power from tractor to implement. Each component of the exploded view is identified by an eight-digit stock number to insure correct identification of each component.

Example: For metric components the 102 prefix denotes a Quick Disconnect Tractor Yoke on the exploded view.

When ordering any component in the exploded view (for any series), be sure the stock number begins with the appropriate three-digit prefix.

The digit immediately following the dash (-) will be a 6, 7 or 8.

A 6 indicates the item is interchangeable with Bondioli & Pavesi ONLY.

A 7 indicates the item is interchangeable with Walterscheid ONLY.

An 8 indicates the item is interchangeable with BOTH Bondioli & Pavesi AND Walterscheid.

This interchangeability designation is used for all components EXCEPT roll pins, guards and guard bearings.

The following chart lists the approximate size replacement for Metric Driveline. These are not an exact interchange, and should be used as a general replacement guide only.

CROSS & BEARING KIT CROSS REFERENCE CHART FOR METRIC COMPONENTS

Cross & Bearing R-Kit Stock #	Cross & Bearing E-KIT Stock No.	Interchanges with Bondioli & Pavesi Series	Interchanges with Walterscheid Series
200-6154	201-6154	1	N/A
200-6580	201-6580	5	N/A
200-6794	201-6794	7N	N/A
200-6806	201-6806	8	N/A
200-6908	201-6908	9	N/A
200-7004	201-7004	N/A	2600
200-7155	201-7155	N/A	2100
200-7676	201-7676	N/A	2400
200-7890	N/A	11	N/A
200-7989	201-7989	N/A	2500
200-8261	201-8261	2	2200
200-8370	201-8370	3	1
200-8474	201-8474	4	2300
200-8692	201-8692	6	220
200-8706	201-8706	7 (Old Series)	230
200-7276	201-7276	N/A	2280
200-7491	201-7491	N/A	2380
200-7694	201-7694	N/A	2480
200-7906	201-7906	N/A	2580

DRIVELINE REPLACEMENT CHART

Weasler Series	Replacement for:	Weasler Series	Replacement for:
6	Bondioli & Pavesi 1 & 2 Series Walterscheid 2100 & 2200 Series	35	Bondioli & Pavesi 5 Series Walterscheid 220 & 2400 Series
12	Bondioli & Pavesi 3 Series Walterscheid I Series	44	Bondioli & Pavesi 6 & 7 Series Walterscheid II Series
14	Bondioli & Pavesi 4 Series Walterscheid 2300 Series	55	Bondioli & Pavesi 8 & 9 Series Walterscheid 2500 & 2600 Series

AW11

I Series

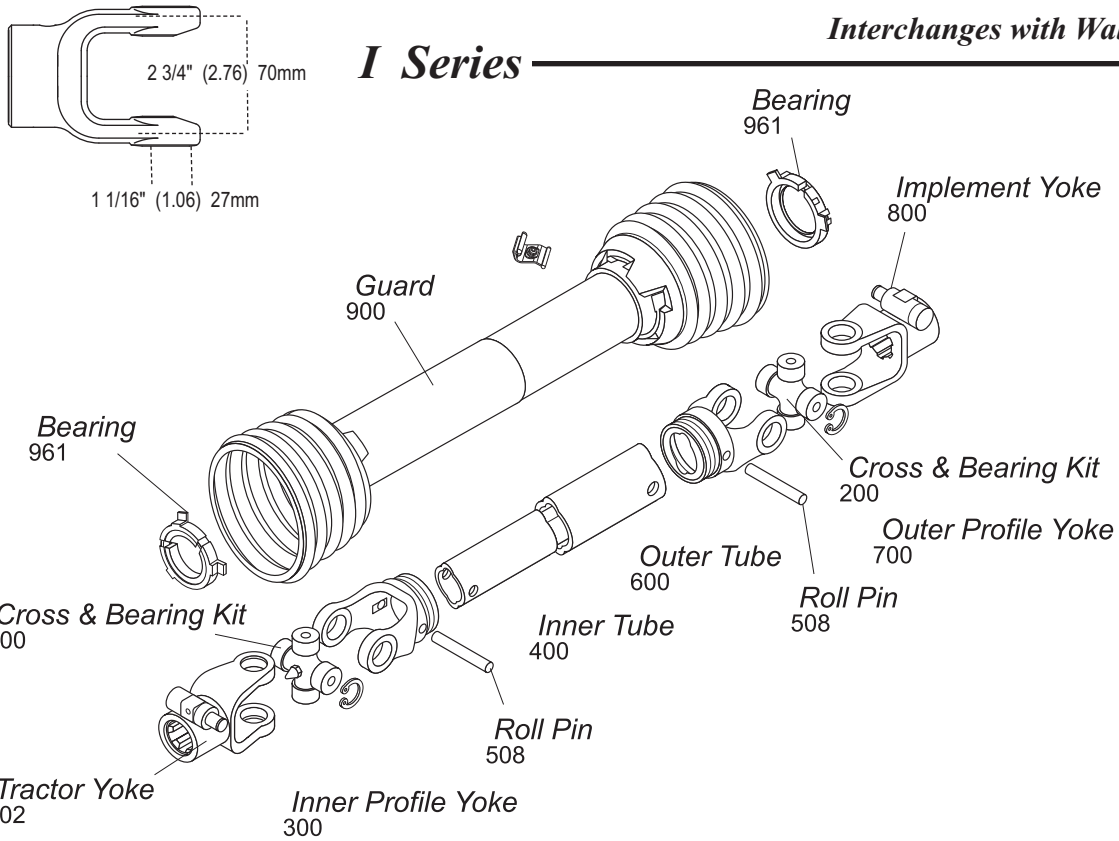

Cross & Bearing Kit and Outboard Yokes interchange with Bondioli 3 Series

Tractor Yoke

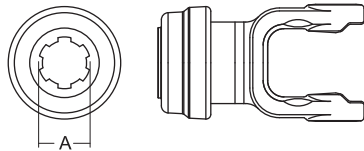

Safety Slide Lock
Repair Kit — Page 139

Stock Number	Dim. "A" Bore
101-8306	1 3/8" × 6 Spl.
101-8321	1 3/8" × 21 Spl.

Cross & Bearing Kit (R-Kit)

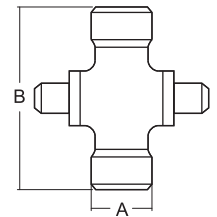

Snap Ring Located In Yoke

Stock Number	Dim. "A" mm	in	Dim. "B" mm	in
200-8370	27.0	1 1/16" (1.06)	70.0	2 3/4" (2.76)

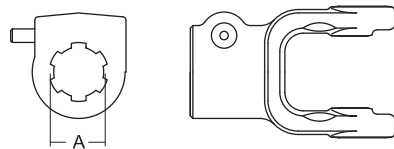

Quick Disconnect
Repair Kit — Page 139

Stock Number	Dim. "A" Bore
102-8306	1 3/8" × 6 Spl.
102-8321	1 3/8" × 21 Spl.

Extended Lubrication Cross & Bearing Kit (E-Kit)

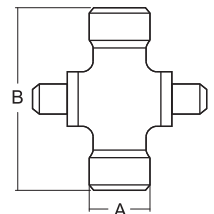

Snap Ring Located In Yoke

Stock Number	Dim. "A" mm	in	Dim. "B" mm	in
201-8370	27.0	1 1/16" (1.06)	70.0	2 3/4" (2.76)

I Series (cont'd.)

Inner Profile Yoke

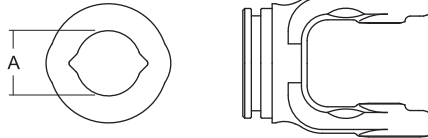

With Bearing Groove
(Guard must rotate freely on yoke)

Stock Number	Dim. "A" Bore	
	mm	in
300-7334	34.5	1 23/64" (1.36)

Outer Profile Yoke

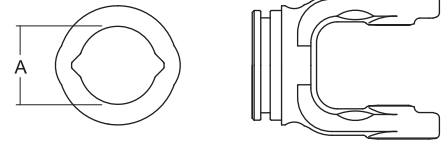

With Bearing Groove
(Guard must rotate freely on yoke)

Stock Number	Dim. "A" Bore	
	mm	in
700-7341	41.3	1 5/8" (1.63)

Inner Tube

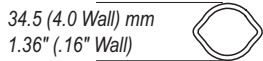

Stock Number	Length	
	m	in
400-7234	1.5	59 1/16" (59.06)
404-7234	1.0	39 3/8" (39.37)

Implement Yoke

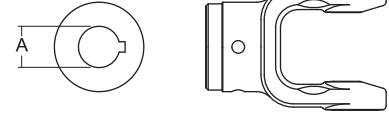

Round Bore
With Keyway & Set Screw

Stock Number	Dim. "A" Bore		Standard Keyway	
	mm	in	mm	in
800-8325	25.0	63/64" (.98)	8.0	5/16" (.31)
800-8330	30.0	1 3/16" (1.18)	8.0	5/16" (.31)
800-8310	31.8	1 1/4" (1.25)	6.4	1/4" (.25)
800-8311	34.9	1 3/8" (1.37)	8.0	5/16" (.31)

Roll Pin

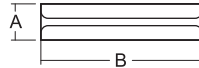

Stock Number	Dim. "A"		Dim. "B"	
	mm	in	mm	in
508-1065	10.0	25/64" (.39)	65.0	2 9/16" (2.56)

Outer Tube

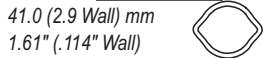

Stock Number	Length	
	m	in
600-7241	1.5	59 1/16" (59.06)
604-7241	1.0	39 3/8" (39.37)

Shear Pin
With Pin Hole

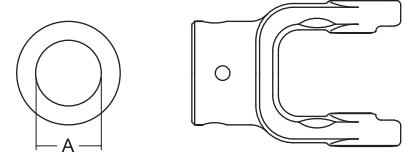

Stock Number	Dim. "A" Bore	
	mm	in
802-8310	31.8	1 1/4" (1.25)
802-8325	25.0	63/64" (.98)
802-8330	30.0	1 3/16" (1.18)
802-8335	35.0	1 3/8" (1.38)

Guard

Order Bearings As Required

Stock Number	Overall Driveline Length	Bearing Kit (2-per kit)
900-2548	48"	961-0251
900-2560	60"	961-0251

Assembly instructions included with guard

Note: When installing Guards observe the following:

- 1) Install proper nylon bearing (See Page 14)
- 2) Guard must rotate freely on yoke

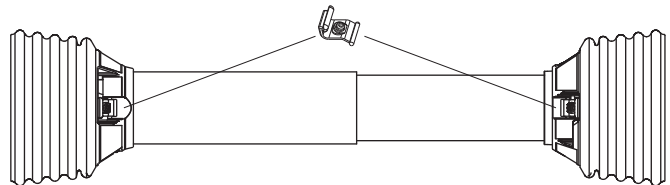

Easy Lock™ Replacement Kit

Part Number: 13005000 (4-per Kit)



Interchanges with Walterscheid

2300/210 Series

AW21

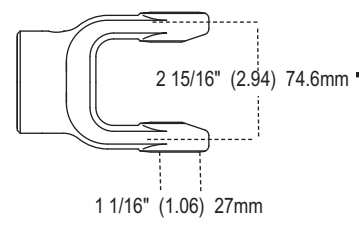

2 15/16" (2.94) 74.6mm
1 1/16" (1.06) 27mm

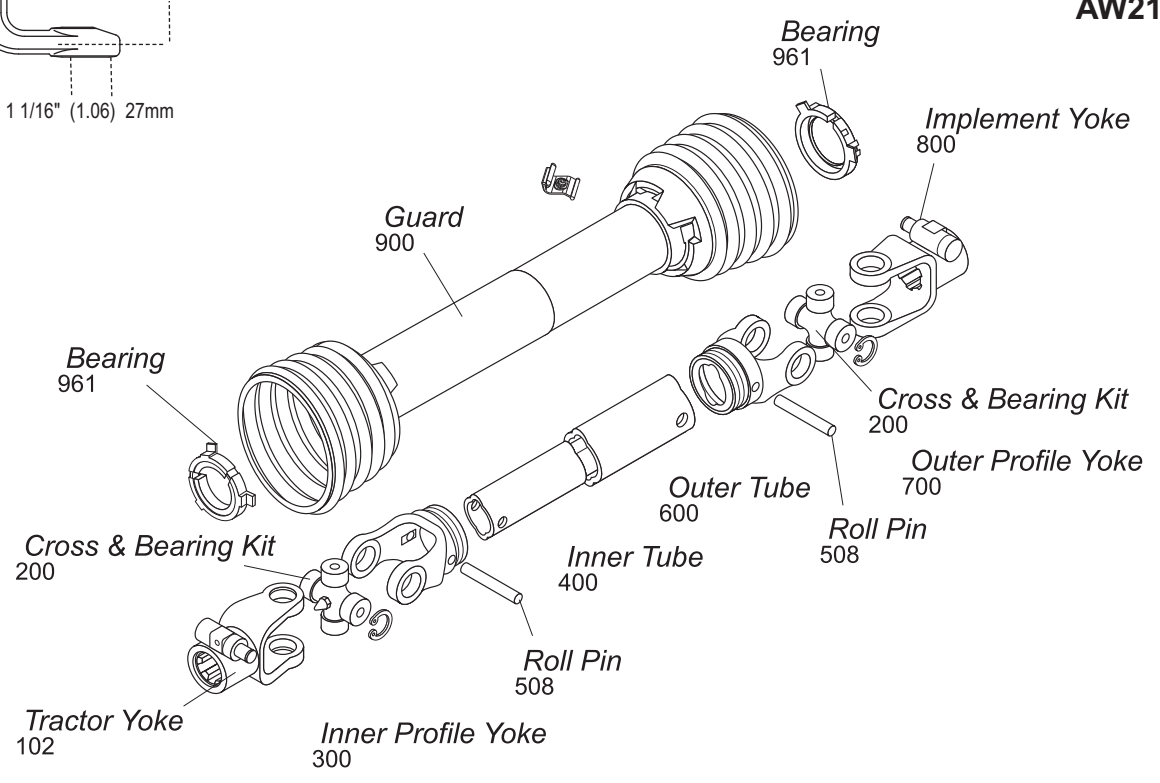

Cross & Bearing Kit and Outboard Yokes interchange with Bondioli 4 Series

Tractor Yoke

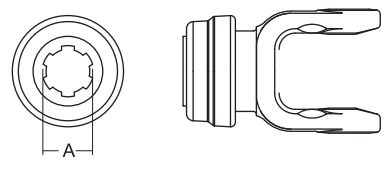

Safety Slide Lock
Repair Kit — Page 139

Stock Number	Dim. "A" Bore
101-8406	1 3/8" x 6 Spl.
101-8421	1 3/8" x 21 Spl.

Ball Shear

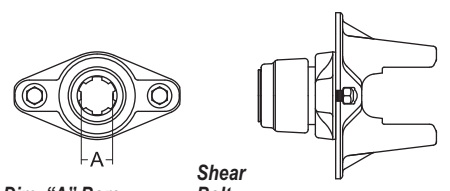

Stock Number	Dim. "A" Bore	Shear Bolt
104-8406	1 3/8" x 6 Spl.	3/8" - 16 Gr. 5
104-8420	1 3/4" x 20 Spl.	3/8" - 16 Gr. 5
104-8421	1 3/8" x 21 Spl.	3/8" - 16 Gr. 5

Quick Disconnect
Repair Kit — Page 139

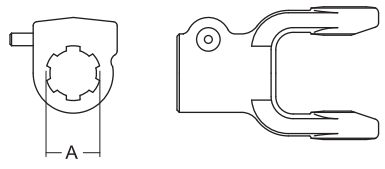

Stock Number	Dim. "A" Bore
102-8406	1 3/8" x 6 Spl.
102-8418	1 1/8" Hex
102-8421	1 3/8" x 21 Spl.

Cross & Bearing Kit (R-Kit)

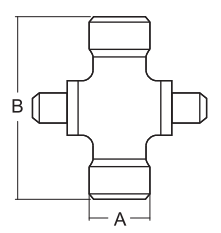

Snap Ring Located In Yoke

Stock Number	Dim. "A" mm	in	Dim. "B" mm	in
200-8474	27.0	1 1/16" (1.06)	74.6	2 15/16" (2.94)

Extended Lubrication Cross & Bearing Kit (E-Kit)

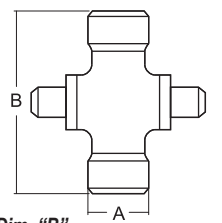

Snap Ring Located In Yoke

Stock Number	Dim. "A" mm	in	Dim. "B" mm	in
201-8474	27.0	1 1/16" (1.06)	74.6	2 15/16" (2.94)

2300/210 Series (cont'd.)

Inner Profile Yoke

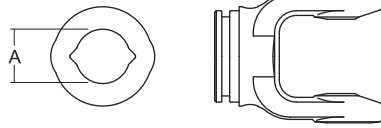

With Bearing Groove
(Guard must rotate freely on yoke)

Stock Number	Dim. "A" mm	Bore in
300-7434	34.5	1 11/32" (1.36)
300-7439	39.5	1 9/16" (1.56)

*Uses 902-3548 Guard & 961-3525 Bearing Kit

Outer Profile Yoke

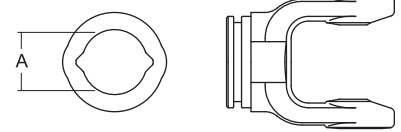

With Bearing Groove
(Guard must rotate freely on yoke)

Stock Number	Dim. "A" mm	Bore in
700-7441	41.3	1 5/8" (1.63)
701-7448*	48.0	1 57/64" (1.89)

*Uses 902-3548 Guard & 961-3525 Bearing Kit

Inner Tube

34.5 (4.0 Wall) mm
1.36" (.16" Wall)



Stock Number	Length m	in
400-7234	1.5	59 1/16" (59.06)
404-7234	1.0	38 3/8" (39.37)

Roll Pin

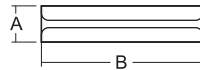

Stock Number	Dim. "A" mm	in	Dim. "B" mm	in
508-1065	10.0	25/64" (.39)	65.0	2 9/16" (2.56)

Outer Tube

41.0 (2.9 Wall) mm
1.61" (.114" Wall)



Stock Number	Dim. "A" mm	Length m	in
600-7241	41.0 (3.0 Wall)	1.5	59 1/16" (59.06)
604-7241	41.0 (3.0 Wall)	1.0	39 3/8" (39.37)

Implement Yoke

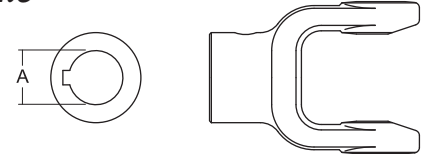

Round Bore
With Keyway & Set Screw

Stock Number	Dim. "A" mm	Bore in	Standard Keyway mm	in
800-8430	30.0	1 3/16" (1.18)	8.0	5/16" (.31)
800-8410	31.8	1 1/4" (1.25)	6.4	1/4" (.25)
800-8411	34.9	1 3/8" (1.38)	8.0	5/16" (3.1)
800-8424	38.1	1 1/2" (1.50)	9.5	3/8" (.38)
800-8435	35.0	1 3/8" (1.38)	10.0	25/64" (.39)

Shear Pin
With Pin Hole

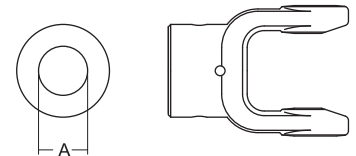

Stock Number	Dim. "A" mm	Bore in
802-8420	31.8	1 1/4" (1.25)
802-8430	30.0	1 3/16" (1.18)
802-8435	35.0	1 3/8" (1.38)

Guard

Order Bearings As Required

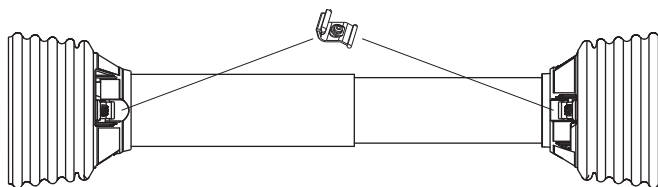

Stock Number	Overall Driveline Length	Bearing Kit (2-per kit)
900-2548	48"	961-0251
900-2560	60"	961-0251

Assembly instructions included with guard

Note: When installing Guards observe the following:

- 1) Install proper nylon bearing (See Page 14)
- 2) Guard must rotate freely on yoke

Easy Lock™ Replacement Kit

Part Number: 13005000 (4-per Kit)



220/720 Series

AW22

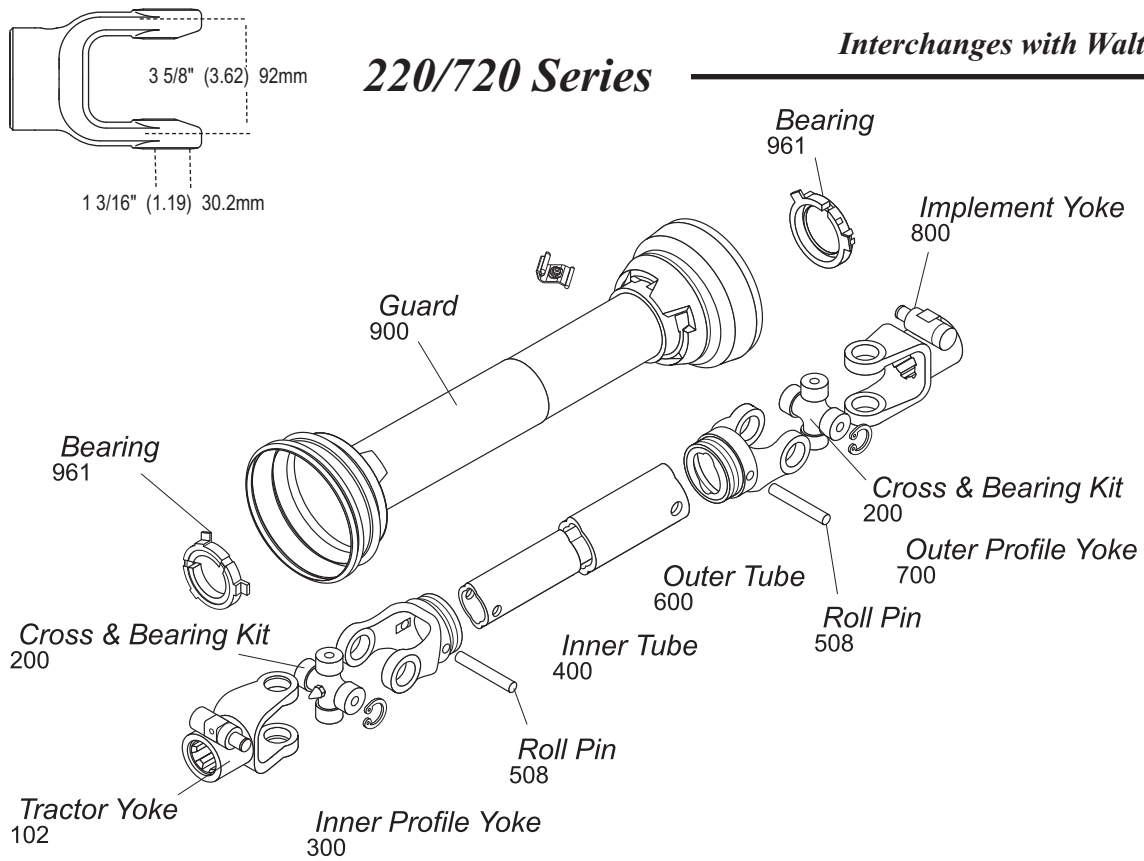

Cross & Bearing Kit and Outboard Yokes interchange with Bondioli 6 Series

Tractor Yoke

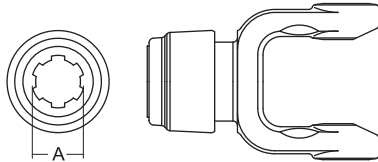

Safety Slide Lock
Repair Kit — Page 139

Stock Number	Dim. "A" Bore
101-8606	1 3/8" × 6 Spl.
101-8620	1 3/4" × 20 Spl.
101-8621	1 3/8" × 21 Spl.

Quick Disconnect
Repair Kit — Page 139

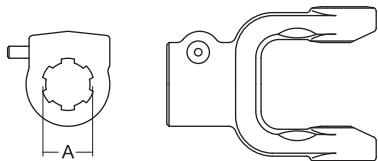

Stock Number	Dim. "A" Bore
102-8606	1 3/8" × 6 Spl.
102-8618	1 1/8" Hex
102-8620	1 3/4" × 20 Spl.
102-8621	1 3/8" × 21 Spl.

Ball Shear

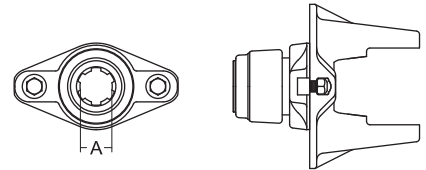

Stock Number	Dim. "A" Bore	Shear Bolt
104-8606	1 3/8" × 6 Spl.	3/8" - 16 Gr. 5
104-8620	1 3/4" × 20 Spl.	3/8" - 16 Gr. 5
104-8621	1 3/8" × 21 Spl.	3/8" - 16 Gr. 5

Cross & Bearing Kit (R-Kit)

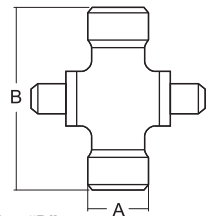

Snap Ring Located In Yoke

Stock Number	Dim. "A"		Dim. "B"	
	mm	in	mm	in
200-8692	30.2	1 3/16" (1.19)	92.0	3 5/8" (3.62)

Extended Lubrication Cross & Bearing Kit (E-Kit)

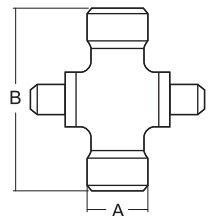

Snap Ring Located In Yoke

Stock Number	Dim. "A"		Dim. "B"	
	mm	in	mm	in
201-8692	30.2	1 3/16" (1.19)	92.0	3 5/8" (3.62)

Inner Profile Yoke

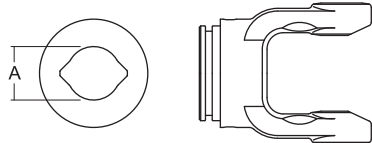

With Bearing Groove
(Guard must rotate freely on yoke)

Stock Number	Dim. "A" Bore	
	mm	in
300-7539	39.5	1 9/16" (1.56)

Outer Profile Yoke

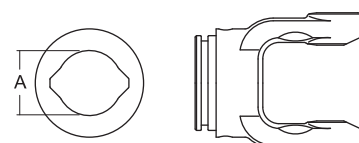

With Bearing Groove
(Guard must rotate freely on yoke)

Stock Number	Dim. "A" Bore	
	mm	in
700-7548	48.0	1 57/64" (1.89)

Inner Tube

39.5 (4.5 Wall) mm
1.56" (.18" Wall)



Stock Number	Length	
	m	in
400-7539	1.5	59 1/16" (59.06)
404-7539	1.0	39 3/8" (39.37)

Implement Yoke

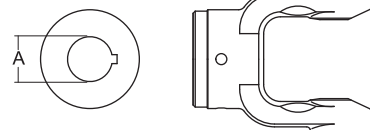

Round Bore
With Keyway & Set Screw

Stock Number	Dim. "A" Bore		Standard Keyway	
	mm	in	mm	in
800-8610	31.8	1 1/4" (1.25)	6.4	1/4" (.25)
800-8611	34.9	1 3/8" (1.38)	8.0	5/16" (.31)
800-8624	38.1	1 1/2" (1.50)	9.5	3/8" (.38)
800-8628	44.5	1 3/4" (1.75)	9.5	3/8" (.38)
800-8635	35.0	1 3/8" (1.38)	10.0	25/64" (.39)
800-8640	40.0	1 37/64" (1.57)	12.0	15/32" (.47)

Roll Pin

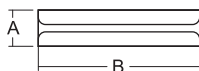

Stock Number	Dim. "A"		Dim. "B"	
	mm	in	mm	in
508-1080	10.0	25/64" (.39)	80.0	3 5/32" (3.10)

Outer Tube

48.0 (3.8 Wall) mm
1.89" (.15" Wall)



Stock Number	Length	
	m	in
600-7548	1.5	59 1/16" (59.06)
604-7548	1.0	39 3/8" (39.37)

Shear Pin

With Pin Hole

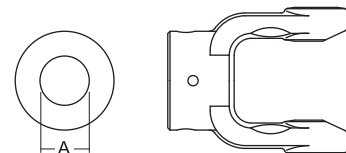

Stock Number	Dim. "A" Bore	
	mm	in
802-8611	35.0	1 3/8" (1.38)
802-8620	31.8	1 1/4" (1.25)

Guard

Order Bearings As Required

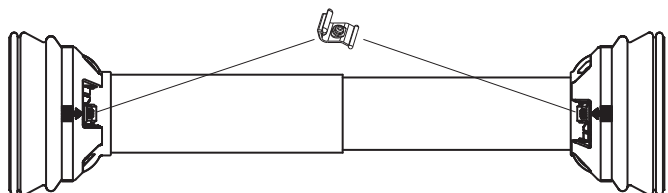

Stock Number	Overall Driveline Length	Bearing Kit (2-per kit)
902-3548	48"	961-3525
902-3560	60"	961-3525

Assembly instructions included with guard

Note: When installing Guards observe the following:

- 1) Install proper nylon bearing (See Page 14)
- 2) Guard must rotate freely on yoke

Easy Lock™ Replacement Kit

Part Number: 13005000 (4-per Kit)



2400 Series

AW35

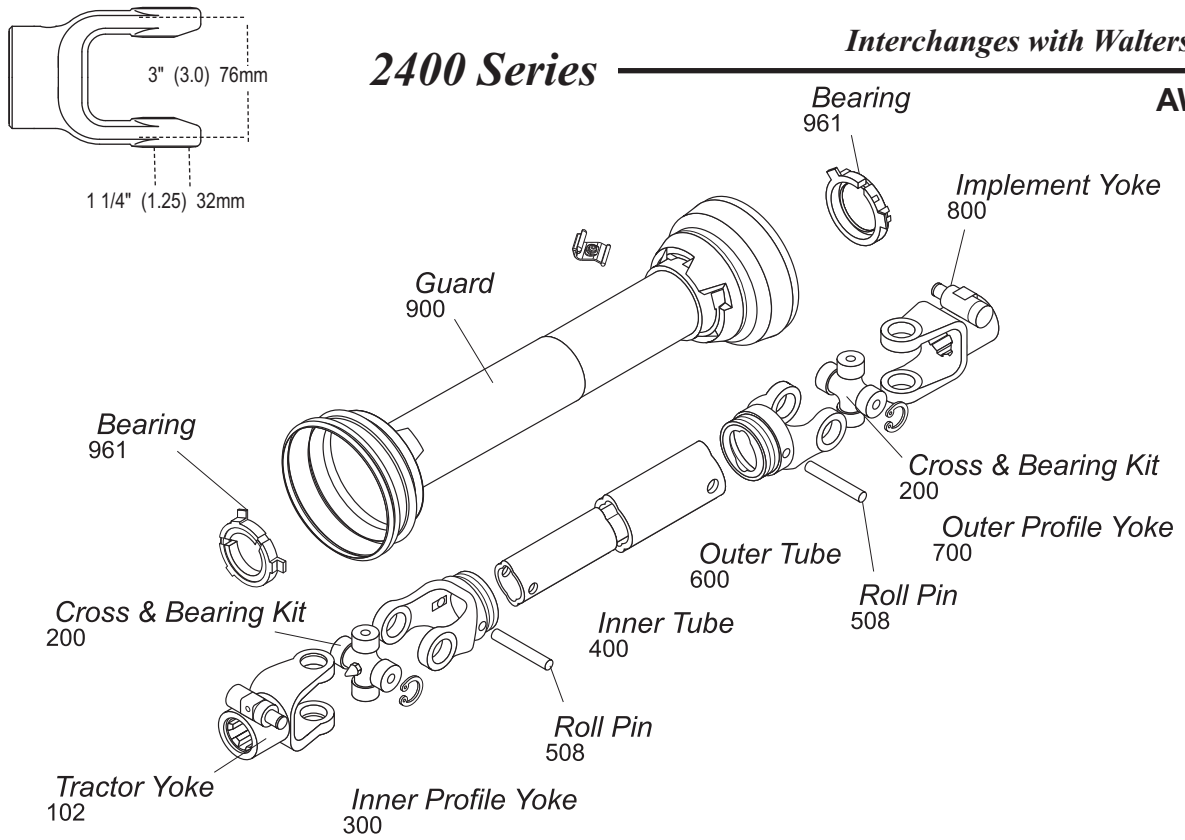

Tractor Yoke

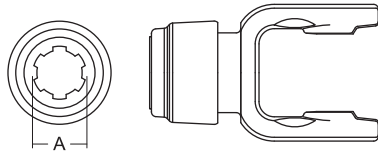

Safety Slide Lock
Repair Kit — Page 139

Stock Number	Dim. "A" Bore
101-7606	1 3/8" x 6 Spl.
101-7618	1 1/8" Hex
101-7620	1 3/4" x 20 Spl.
101-7621	1 3/8" x 21 Spl.

Cross & Bearing Kit (R-Kit)

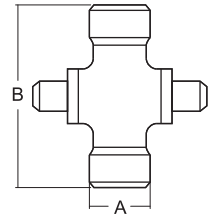

Snap Ring Located In Yoke

Stock Number	Dim. "A"		Dim. "B"	
	mm	in	mm	in
200-7676	32.0	1 1/4"(1.26)	76.0	3"(3.00)

Quick Disconnect

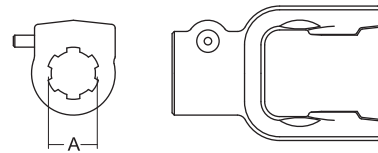

Repair Kit — Page 139

Stock Number	Dim. "A" Bore
102-7606	1 3/8" x 6 Spl.
102-7620	1 3/4" x 20 Spl.
102-7621	1 3/8" x 21 Spl.

Extended Lubrication Cross & Bearing Kit (E-Kit)

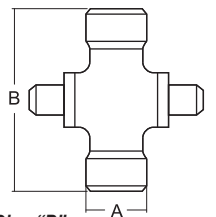

Snap Ring Located In Yoke

Stock Number	Dim. "A"		Dim. "B"	
	mm	in	mm	in
201-7676	32.0	1 1/4"(1.26)	76.0	3"(3.00)

Ball Shear

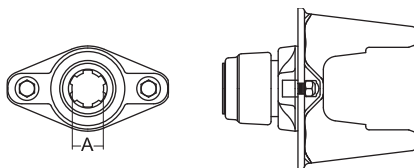

Stock Number	Dim. "A" Bore	Shear Bolt
104-7606	1 3/8" x 6 Spl.	3/8" - 16 Gr. 5
104-7620	1 3/4" x 20 Spl.	3/8" - 16 Gr. 5
104-7621	1 3/8" x 21 Spl.	3/8" - 16 Gr. 5

Inner Profile Yoke

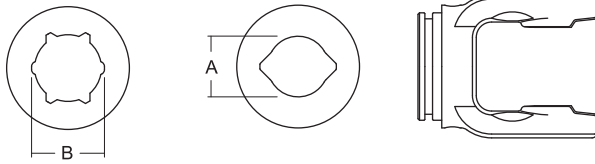

With Bearing Groove
(Guard must rotate freely on yoke)

Stock Number	Dim. "A" Profile		Dim. "B" Profile	
	mm	in	mm	in
300-7639 (Lemon)	39.5	1 9/16" (1.56)		
300-7651 (Star)			51.4	2 1/64" (2.02)

Outer Profile Yoke

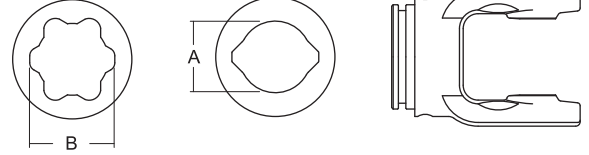

With Bearing Groove
(Guard must rotate freely on yoke)

Stock Number	Dim. "A" Bore		Dim. "B" Bore	
	mm	in	mm	in
700-7648	48.0	1 7/8" (1.89)		
700-7661			61.0	2 13/32" (2.40)

Inner Tube

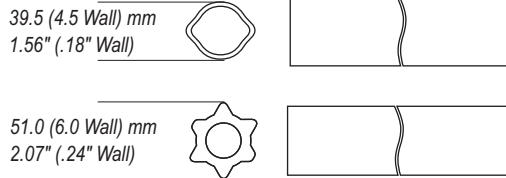

Stock Number	Length	
	m	in
400-7539 (Lemon)	1.5	59 1/16" (59.06)
400-7651 (Star)	1.5	59 1/16" (59.06)
404-7539 (Lemon)	1.0	39 3/8" (39.37)
404-7651 (Star)	1.0	39 3/8" (39.37)

Implement Yoke

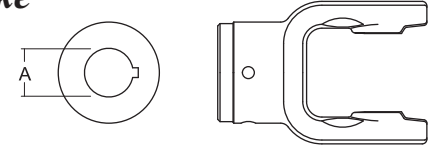

Round Bore
With Keyway & Set Screw

Stock Number	Dim. "A" Bore		Standard Keyway	
	mm	in	mm	in
800-7610	31.8	1 1/4" (1.25)	6.4	1/4" (.25)
800-7611	34.9	1 3/8" (1.38)	8.0	5/16" (.31)
800-7635	35.0	1 3/8" (1.38)	10.0	25/64" (.39)
800-7640	40.0	1 37/64" (1.57)	12.0	15/32" (.47)

Roll Pin

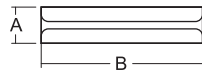

Stock Number	Dim. "A"		Dim. "B"	
	mm	in	mm	in
508-1075	10.0	25/64" (.394)	75.0	2 61/64" (2.95)

Shear Pin
With Pin Hole

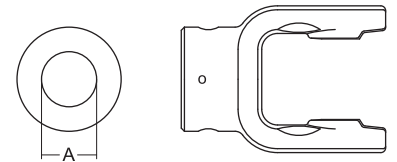

Stock Number	Dim. "A" Bore
mm	in
802-7611 (1/2" Pinhole)	35.0 1 3/8" (1.38)
802-7630 (10-mm Pinhole)	30.0 1 3/16" (1.18)
802-7640 (13-mm Pinhole)	40.0 1 37/64" (1.57)

Outer Tube

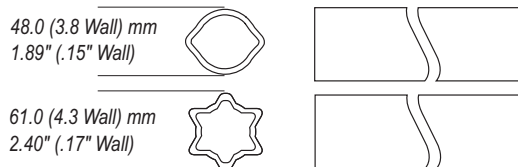

Stock Number	Length	
	m	in
600-7548 (Lemon)	1.5	59 1/16" (59.06)
600-7961 (Star)	1.5	59 1/16" (59.06)
604-7548 (Lemon)	1.0	39 7/8" (39.37)
604-7961 (Star)	1.0	39 7/8" (39.37)

Clamp Yoke

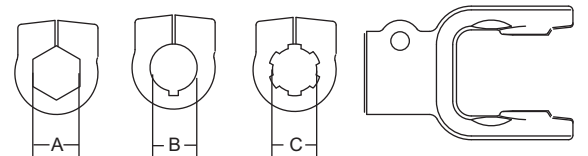

Stock Number	Dim. "A" Bore	Dim. "B" Bore	Dim. "C" Bore
807-7606			1 3/8" x 6 Spl. (1.38)
807-7618	1 1/8" Hex (1.12)		
807-7620			1 3/4" x 20 Spl. (1.75)
807-7621			1 3/8" x 21 Spl. (1.38)
807-7622		1 3/8" Rd. Bore (1.38)	

2400 Series (cont'd.)

Guard

Order Bearings As Required

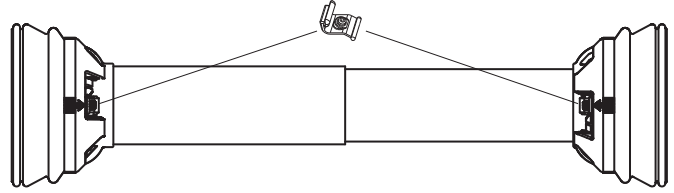

Stock Number	Overall Driveline Length	Bearing Kit (2-per kit)
902-3548	48"	961-3525
902-3560	60"	961-3525

Assembly instructions included with guard

Note: When installing Guards observe the following:

- 1) Install proper nylon bearing (See Page 14)
- 2) Guard must rotate freely on yoke

Easy Lock™ Replacement Kit

Part Number: 13005000 (4-per Kit)

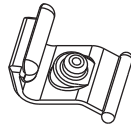

Drivelines

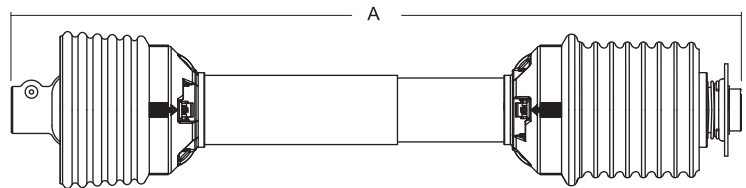

Stock Number	Overall Comp. Length Dim. "A"	Tractor Yoke	Implement Yoke
14007631	31"	1 3/8" x 21 Spl. Safety Slide Lock	1 1/8" Hex Clamp
14007633	33"	1 1/8" Hex Safety Slide Lock	1 1/8" Hex Clamp
14007635	35"	1 3/8" x 21 Spl. Safety Slide Lock	1 1/8" Hex Clamp
14007640	40"	1 3/8" x 6 Spl. QD	1 3/8" x 6 Spl. QD
14307645	45"	1 3/8" x 6 Spl. QD	1 3/8" x 6 Spl. w/Overrunning Clutch

Interchanges with Walterscheid

2500 Series

AW36

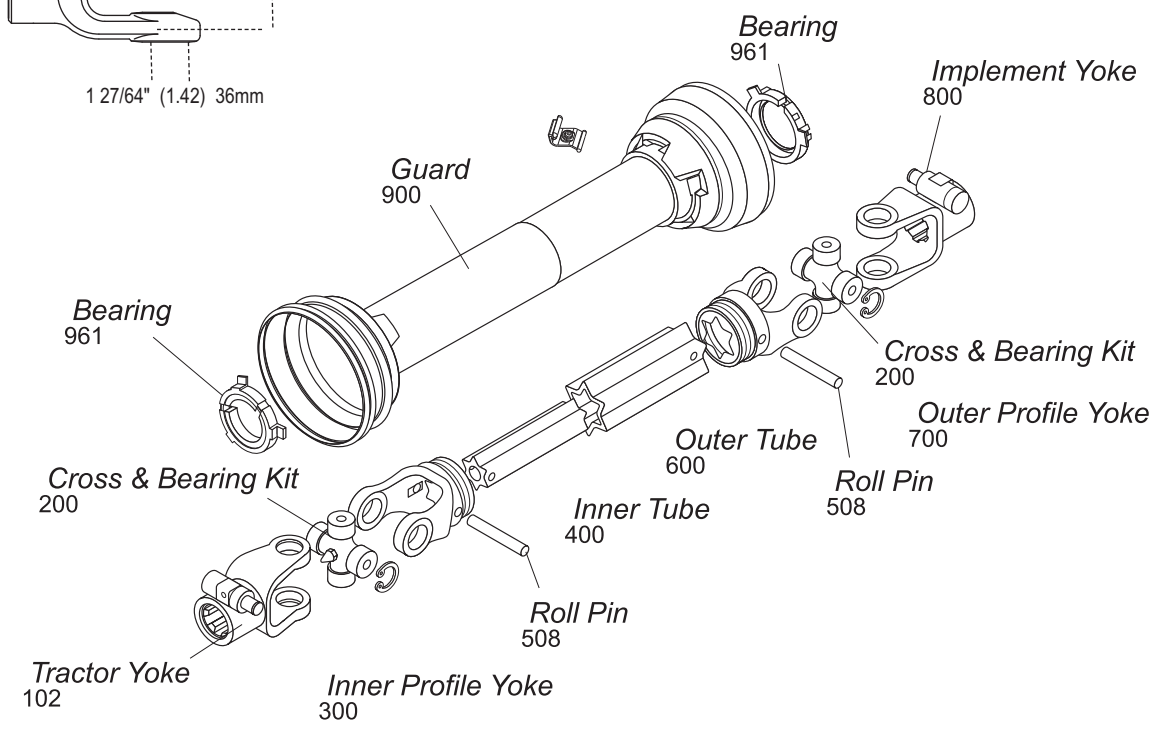
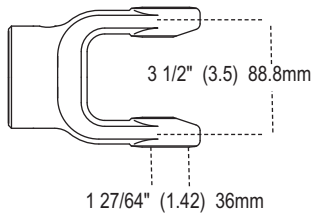

Tractor Yoke

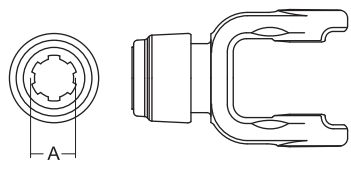

Safety Slide Lock
Repair Kit — Page 139

Stock Number	Dim. "A" Bore
101-7906	1 3/8" × 6 Spl.
101-7920	1 3/4" × 20 Spl.
101-7921	1 3/8" × 21 Spl.

Cross & Bearing Kit (R-Kit)

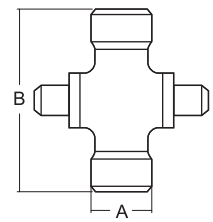

Snap Ring Located In Yoke

Stock Number	Dim. "A"		Dim. "B"	
	mm	in	mm	in
200-7989	36.0	1 27/64" (1.42)	88.8	3 1/2" (3.50)

Quick Disconnect
Repair Kit — Page 139

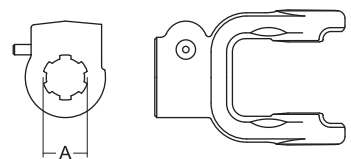

Stock Number	Dim. "A" Bore
102-7906	1 3/8" × 6 Spl.
102-7920	1 3/4" × 20 Spl.
102-7921	1 3/8" × 21 Spl.

Extended Lubrication Cross & Bearing Kit (E-Kit)

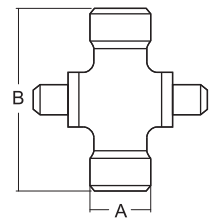

Snap Ring Located In Yoke

Stock Number	Dim. "A"		Dim. "B"	
	mm	in	mm	in
201-7989	36.0	1 27/64" (1.42)	88.8	3 1/2" (3.50)

Ball Shear

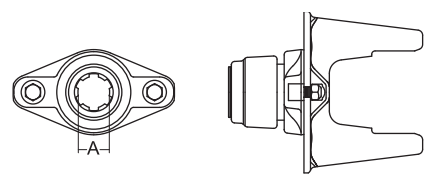

Stock Number	Dim. "A" Bore	Shear Bolt
104-7906	1 3/8" × 6 Spl.	3/8" - 16 Gr. 5
104-7920	1 3/4" × 20 Spl.	3/8" - 16 Gr. 5
104-7921	1 3/8" × 21 Spl.	3/8" - 16 Gr. 5

Auto-Lok
Repair Kit — Page 139

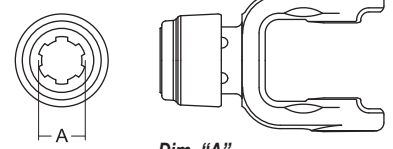

Stock Number	Dim. "A" Bore
110-7906	1 3/8" × 6 Spl.

2500 Series (cont'd.)

Inner Profile Yoke

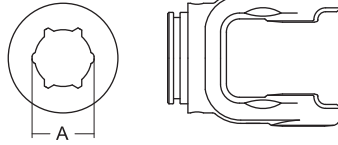

With Bearing Groove
(Guard must rotate freely on yoke)

Stock Number	Dim. "A" Bore	
	mm	in
300-7951	51.4	2 1/64" (2.02)

Inner Tube

51.0 mm (6.0 Wall) mm
2.00" (.24" Wall)

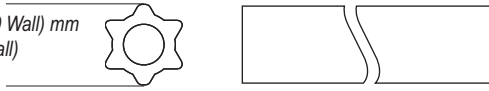

Stock Number	Length	
	m	in
400-7651	1.5	59 1/16" (59.06)
404-7651	1.0	39 3/8" (39.37)

Roll Pin

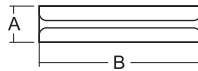

Stock Number	Dim. "A"		Dim. "B"	
	mm	in	mm	in
508-1090	10.0	25/64" (.39)	90.0	3 35/64" (3.54)

Outer Tube

61.0 mm (4.3 Wall) mm
2.40" (.17" Wall)

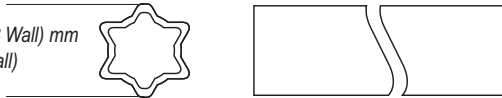

Stock Number	Length	
	m	in
600-7961	1.5	59 1/16" (59.06)
604-7961	1.0	39 3/8" (39.37)

Outer Profile Yoke

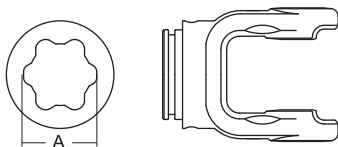

With Bearing Groove
(Guard must rotate freely on yoke)

Stock Number	Dim. "A" Bore	
	mm	in
700-7961	61.0	2 13/32" (2.40)

Implement Yoke

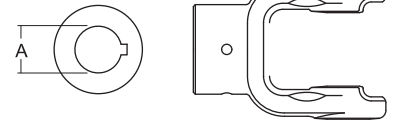

Round Bore
With Keyway & Set Screw

Stock Number	Dim. "A" Bore		Standard Keyway	
	mm	in	mm	in
800-7922	35.0	1 3/8" (1.38)	8.0	5/16" (.31)
800-7924	38.1	1 1/2" (1.50)	9.5	3/8" (.37)
800-7928	44.4	1 3/4" (1.75)	10	3/8" (.37)
800-7935	35.0	1 3/8" (1.38)	10	25/64" (.39)

Spline Bore
With Pin Hole

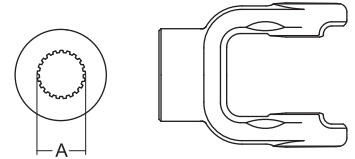

Stock Number	Dim. "A" Bore
801-7921	1 3/8" x 21 Spl.

Shear Pin
With Pin Hole

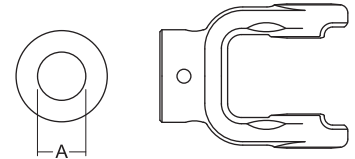

Stock Number	Dim. "A" Bore	
	mm	in
802-7922	35.0	1 3/8" (1.38)
802-7924	38.1	1 1/2" (1.50)

Clamp Yoke

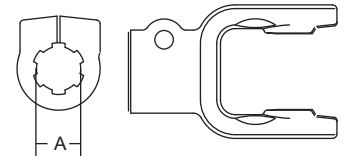

Stock Number	Dim. "A" Bore
807-7906	1 3/8" x 6 Spl.
807-7918	1 3/4" x 6 Spl.
807-7920	1 3/4" x 20 Spl.
807-7921	1 3/8" x 21 Spl.

Guard

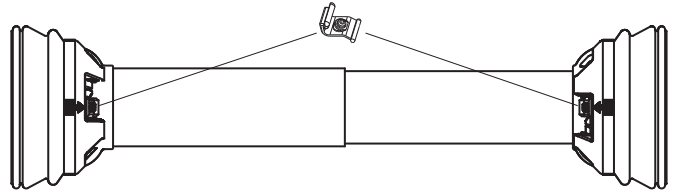

Order Bearings As Required

Stock Number	Overall Driveline Length	Bearing Kit (2-per kit)
902-3548	48"	961-3525
902-3560	60"	961-3525

Assembly instructions included with guard

Note: When installing Guards observe the following:

- 1) Install proper nylon bearing (See Page 14)
- 2) Guard must rotate freely on yoke

Easy Lock™ Replacement Kit

Part Number: 13005000 (4-per Kit)

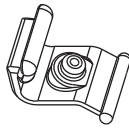

Drivelines

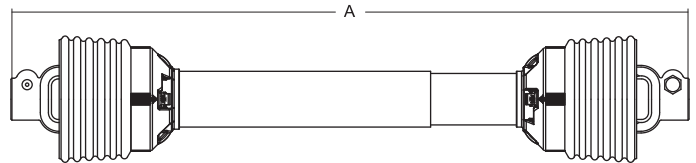

Stock Number	Overall Comp. Length Dim. "A"	Tractor Yoke	Implement Yoke
14007936	36"	1 3/8" x 6 Spl. QD	1 3/8" x 6 Spl. QD
14007940	40"	1 3/8" x 6 Spl. QD	1 3/8" x 6 Spl. QD
14007955	55"	1 3/4" x 20 Spl. QD	1 3/8" x 21 Spl. w/Pinhole
14007957	57"	1 3/8" x 6 Spl. QD	1 3/8" x 6 Spl. QD

2600 Series

AW26

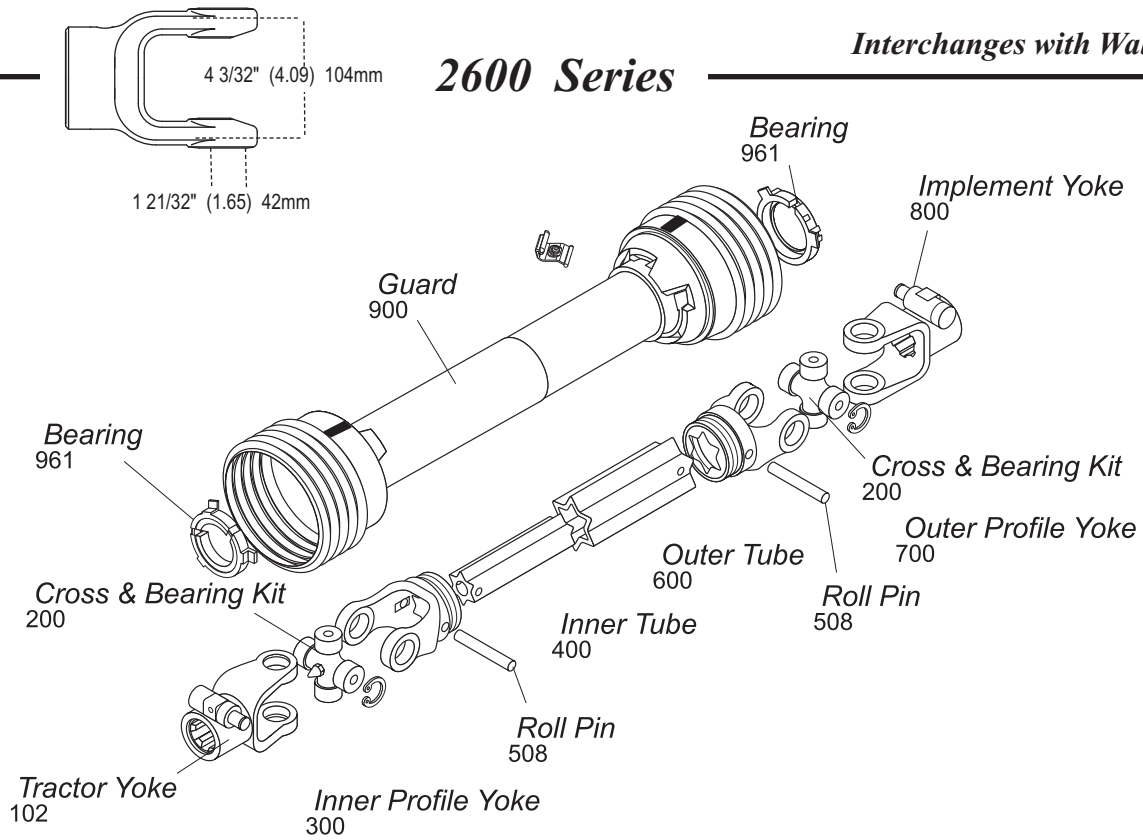

Tractor Yoke

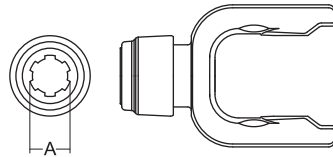

Safety Slide Lock
Repair Kit — Page 139

Stock Number	Dim. "A" Bore
101-7006	1 3/8" × 6 Spl.
101-7020	1 3/4" × 20 Spl.
101-7021	1 3/8" × 21 Spl.

Cross & Bearing Kit (R-Kit)

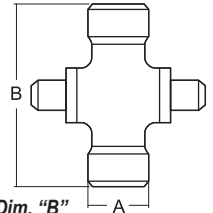

Snap Ring Located In Yoke

Stock Number	Dim. "A"		Dim. "B"	
	mm	in	mm	in
200-7004	42.0	1 21/32" (1.65)	104.0	4 3/32" (4.09)

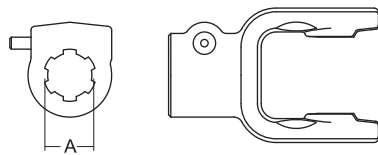

Quick Disconnect
Repair Kit — Page 139

Stock Number	Dim. "A" Bore
102-7006	1 3/8" × 6
102-7020	1 3/4" × 20
102-7021	1 3/8" × 21

Extended Lubrication Cross & Bearing Kit (E-Kit)

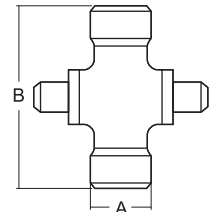

Snap Ring Located In Yoke

Stock Number	Dim. "A"		Dim. "B"	
	mm	in	mm	in
201-7004	42.0	1 21/32" (1.65)	104.0	4 3/32" (4.09)

Inner Profile Yoke

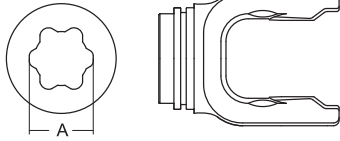

With Bearing Groove
(Guard must rotate freely on yoke)

Stock Number	Dim. "A" Bore	
	mm	in
300-7061	61.0	2 13/32" (2.40)

Outer Tube

71.5 (4.9 Wall) mm
2.81" (.19" Wall)



Stock Number	Length	
	mm	in
600-7071	1.5	59 1/16" (59.06)
604-7071	1.0	39 3/8" (39.37)

Inner Tube

61.0 (4.3 Wall) mm
2.40" (.17" Wall)



Stock Number	Length	
	m	in
600-7961	1.5	59 1/16" (59.06)
604-7961	1.0	39 3/8" (39.37)

Outer Profile Yoke

With Bearing Groove
(Guard must rotate freely on yoke)

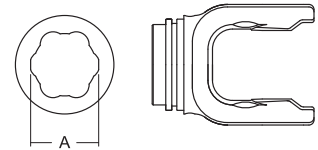

Stock Number	Dim. "A" Bore	
	mm	in
700-7071	71.7	2 53/64" (2.82)

Roll Pin

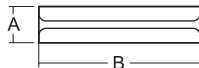

Stock Number	Dim. "A"		Dim. "B"	
	mm	in	mm	in
508-1310	13.0	1/2" (.50)	100.0	3 15/16" (3.69)

Implement Yoke

Round Bore
With Keyway & Set Screw

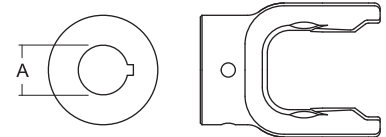

Stock Number	Dim. "A" Bore		Standard Keyway	
	mm	in	mm	in
800-7024	38.1	1 1/2" (1.50)	9.5	3/8" (.37)
800-7026	41.3	1 5/8" (1.63)	9.5	3/8" (.37)
800-7028	44.5	1 3/4" (1.75)	9.5	3/8" (.37)
800-7032	50.8	2" (2.00)	12.7	1/2" (.50)

Guard

Order Bearings As Required

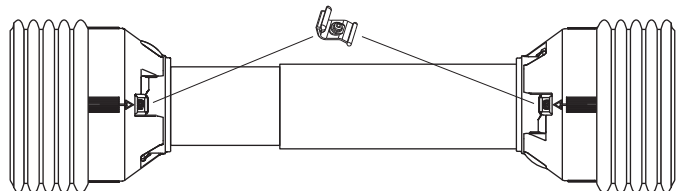

Stock Number	Overall Driveline Length	Bearing Kit (2-per kit)
900-4548	48"	961-4535
900-4560	60"	961-4535

Assembly instructions included with guard

Note: When installing Guards observe the following:

- 1) Install proper nylon bearing (See Page 14)
- 2) Guard must rotate freely on yoke

Easy Lock™ Replacement Kit

Part Number: 13005000 (4-per Kit)



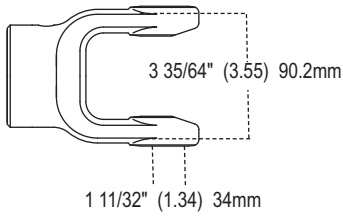

II Series

Interchanges with Walterscheid

AW12

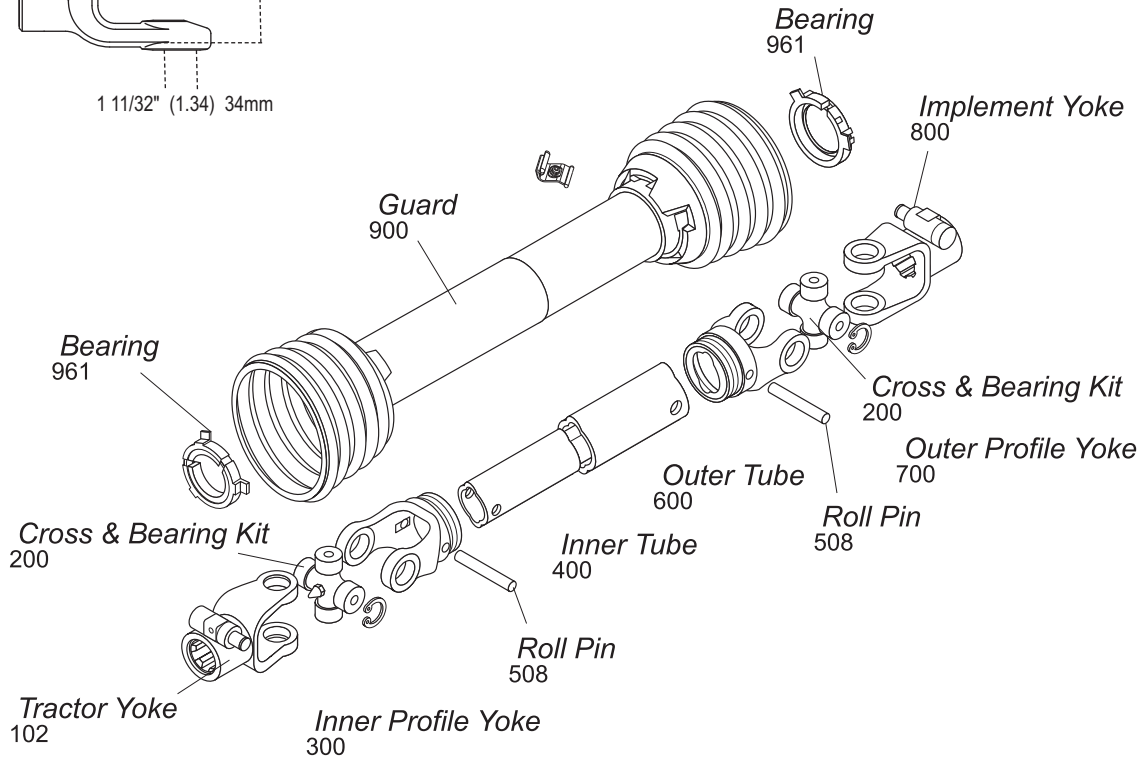

Tractor Yoke

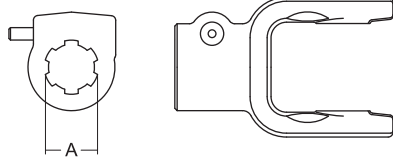

Quick Disconnect
Repair Kit — Page 139

Stock Number	Dim. "A" Bore
102-7806	1 3/8" × 6 Spl.
102-7821	1 3/8" × 21 Spl.

Inner Profile Yoke

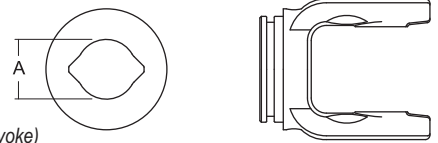

With Bearing Groove
(Guard must rotate freely on yoke)

Stock Number	Dim. "A" Bore	
	mm	in
300-7839	39.5	1 9/16" (1.56)

Cross & Bearing Kit

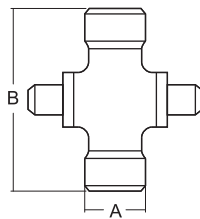

Snap Ring Located In Bushing

Stock Number	Dim. "A"		Dim. "B"	
	mm	in	mm	in
200-7890	34.0	1 11/32" (1.34)	89.9	3 35/64" (3.55)

Outer Profile Yoke

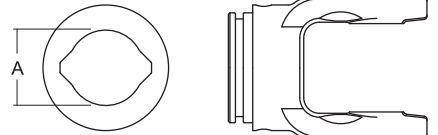

With Bearing Groove
(Guard must rotate freely on yoke)

Stock Number	Dim. "A" Bore	
	mm	in
700-7848	48.0	1 7/8" (1.89)

Profile Shafting and Tubing

GERMAN-STYLE SHAFTING & TUBING

ITALIAN-STYLE SHAFTING & TUBING

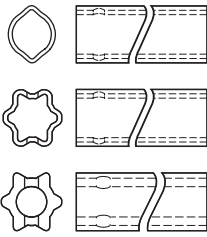

Lemon & Star Profile

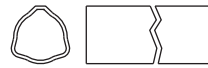

Tri-Lobe Profile

SERIES	STOCK NO.	LENGTH		OUTSIDE DIAMETER		WALL THICKNESS		USE AS	PROFILE
		M	IN.	MM	IN.	MM	IN.		
ByPy 1	400-6126	1.5	59.06	26.5	1.024	3.4	.138	Inner	Tri-Lobe
ByPy 1	404-6126	1	39.37	26.5	1.024	3.4	.138	Inner	Tri-Lobe
ByPy 1	600-6133	1.5	59.06	32.5	1.299	2.6	.102	Outer	Tri-Lobe
ByPy 1	604-6133	1	39.37	32.5	1.299	2.6	.102	Outer	Tri-Lobe
ByPy 2	400-6229	1.5	59.06	29	1.142	4.1	.134	Inner	Tri-Lobe
ByPy 2	404-6229	1	39.37	29	1.142	4.1	.134	Inner	Tri-Lobe
ByPy 2	600-6236	1.5	59.06	36	1.417	3.2	.134	Outer	Tri-Lobe
ByPy 2	604-6236	1	39.37	36	1.417	3.2	.134	Outer	Tri-Lobe
ByPy 3	600-6236	1.5	59.06	36	1.417	3.2	.134	Inner	Tri-Lobe
ByPy 3	604-6236	1	39.37	36	1.417	3.2	.134	Inner	Tri-Lobe
ByPy 3 & 4	600-6343	1.5	59.06	43.5	1.713	3.4	.138	Outer	Tri-Lobe
ByPy 3 & 4	604-6343	1	39.37	43.5	1.713	3.4	.138	Outer	Tri-Lobe
ByPy 4	400-6436	1.5	59.06	36	1.417	3.9	.157	Inner	Tri-Lobe
ByPy 4	404-6436	1	39.37	36	1.417	3.9	.157	Inner	Tri-Lobe
ByPy 5 & 6	400-6545	1.5	59.06	45	1.77	3.9	.150	Inner	Tri-Lobe
ByPy 5 & 6	404-6545	1	39.37	45	1.77	3.9	.150	Inner	Tri-Lobe
ByPy 5	600-6552	1.5	59.06	51.5	2.03	3	.120	Outer	Tri-Lobe
ByPy 5	604-6552	1	39.37	51.5	2.03	3	.120	Outer	Tri-Lobe
ByPy 6 & 7N	600-6654	1.5	59.06	54	2.13	4.5	.180	Outer	Tri-Lobe
ByPy 6 & 7N	604-6654	1	39.37	54	2.13	4.5	.180	Outer	Tri-Lobe
ByPy 7N	400-6745	1.5	59.06	45	1.77	5.4	.210	Inner	Tri-Lobe
ByPy 7N	404-6745	1	39.37	45	1.77	5.4	.210	Inner	Tri-Lobe
ByPy 8	600-6654	1.5	59.06	54	2.13	4.5	.180	Inner	Tri-Lobe
ByPy 8	604-6654	1	39.37	54	2.13	4.5	.180	Inner	Tri-Lobe
ByPy 8 & 9	600-6863	1.5	59.06	63	2.48	4.1	.161	Outer	Tri-Lobe
ByPy 8 & 9	604-6863	1	39.37	63	2.48	4.1	.161	Outer	Tri-Lobe
ByPy 9	400-6954	1.5	59.06	54	2.13	4.9	.190	Inner	Tri-Lobe
ByPy 9	404-6954	1	39.37	54	2.13	4.9	.190	Inner	Tri-Lobe
W/S 2100	400-7123	1.5	59.06	23.5	0.93	SOLID		Inner	Lemon
W/S 2100	404-7123	1	39.37	23.5	0.93			Inner	Lemon
W/S 2100	600-7130	1.5	59.06	30	1.19	2.9	.114	Outer	Lemon
W/S 2100	604-7130	1	39.37	30	1.19	2.9	.114	Outer	Lemon
W/S I, 2200 & 2300	400-7234	1.5	59.06	34.5	1.36	4	.160	Inner	Lemon
W/S I, 2200 & 2300	404-7234	1	39.37	34.5	1.36	4	.160	Inner	Lemon
W/S I, 2200 & 2300	600-7241	1.5	59.06	41	1.61	2.9	.114	Outer	Lemon
W/S I, 2200 & 2300	604-7241	1	39.37	41	1.61	2.9	.110	Outer	Lemon
W/S 2400 & 220/720	400-7539	1.5	59.06	39.5	1.56	4.5	.180	Inner	Lemon
W/S 2400 & 220/720	404-7539	1	39.37	39.5	1.56	4.5	.180	Inner	Lemon
W/S 2400 & 220/720	600-7548	1.5	59.06	48	1.89	3.8	.150	Outer	Lemon
W/S 2400 & 220/720	604-7548	1	39.37	48	1.89	3.8	.150	Outer	Lemon
W/S 2400 & 2500	400-7651	1.5	59.06	51	2.07	6	.240	Inner	Star
W/S 2400 & 2500	404-7651	1	39.37	51	2.07	6	.240	Inner	Star
W/S 2400 & 2500	600-7961	1.5	59.06	61	2.4	4.3	.170	Outer	Star
W/S 2400 & 2500	604-7961	1	39.37	61	2.4	4.3	.170	Outer	Star
W/S 2600	600-7961	1.5	59.06	61	2.4	4.3	.170	Inner	Star
W/S 2600	604-7961	1	39.37	61	2.4	4.3	.170	Inner	Star
W/S 2600	600-7071	1.5	59.06	71.5	2.81	4.9	.190	Outer	Star
W/S 2600	604-7071	1	39.37	71.5	2.81	4.9	.190	Outer	Star

Metric Replacement Drivelines

Interchanges with Bondioli & Pavesi and Walterscheid

All Purpose Drivelines

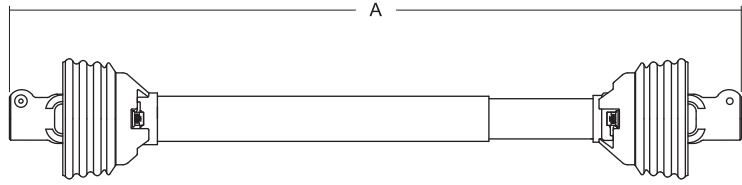

Stock Number	Series	Overall Comp. Length Dim. "A"	Tractor Yoke	Implement Yoke
14006137	BYPY 1	37"	1 3/8" x 6 Spl. QD	1 3/8" x 6 Spl. QD
14006247	BYPY 2	47"	1 3/8" x 6 Spl. QD	1 3/8" x 6 Spl. QD
14006438	BYPY 4	38"	1 3/8" x 6 Spl. QD	1 3/8" x 6 Spl. QD
14006455	BYPY 4	55"	1 3/8" x 6 Spl. QD	1 3/8" x 6 Spl. QD
14006448	BYPY 4	48"	1 3/8" x 6 Spl. QD	1 3/8" x 6 Spl. QD
14006543	BYPY 5	43"	1 3/8" x 6 Spl. QD	1 3/8" x 6 Spl. QD
14006555	BYPY 5	55"	1 3/8" x 6 Spl. QD	1 3/8" x 6 Spl. QD
14006642	BYPY 6	42"	1 3/8" x 6 Spl. QD	1 3/8" x 6 Spl. QD
14006644	BYPY 6	44"	1 3/8" x 6 Spl. QD	1 3/8" x 6 Spl. QD
14006655	BYPY 6	55"	1 3/8" x 6 Spl. QD	1 3/8" x 6 Spl. QD
14006657	BYPY 6	57"	1 3/8" x 6 Spl. QD	1 3/8" x 6 Spl. QD
14006846	BYPY 8	46"	1 3/8" x 6 Spl. QD	1 3/8" x 6 Spl. QD
14006857	BYPY 8	57"	1 3/8" x 6 Spl. QD	1 3/8" x 6 Spl. QD
14016542	BYPY 5	42"	1 3/8" x 6 Spl. QD	1 3/8" x 6 Spl. QD
14016666	BYPY 6	66"	1 3/8" x 21 Spl. QD	1 1/2" Rd.
14046148	BYPY 1	48"	1 3/8" x 6 Spl. QD	*
14046248	BYPY 2	48"	1 3/8" x 6 Spl. QD	*
14046260	BYPY 2	60"	1 3/8" x 6 Spl. QD	*
14046348	BYPY 3	48"	1 3/8" x 6 Spl. QD	*
14046360	BYPY 3	60"	1 3/8" x 6 Spl. QD	*
14046448	BYPY 4	48"	1 3/8" x 6 Spl. QD	*
14046460	BYPY 4	60"	1 3/8" x 6 Spl. QD	*
14046548	BYPY 5	48"	1 3/8" x 6 Spl. QD	*
14046560	BYPY 5	60"	1 3/8" x 6 Spl. QD	*
14046648	BYPY 6	48"	1 3/8" x 6 Spl. QD	*
14046660	BYPY 6	60"	1 3/8" x 6 Spl. QD	*
14046748	BYPY 7	48"	1 3/8" x 6 Spl. QD	*
14046760	BYPY 7	60"	1 3/8" x 6 Spl. QD	*
14046848	BYPY 8	48"	1 3/8" x 6 Spl. QD	*
14046860	BYPY 8	60"	1 3/8" x 6 Spl. QD	*
14046948	BYPY 9	48"	1 3/8" x 6 Spl. QD	*
14046960	BYPY 9	60"	1 3/8" x 6 Spl. QD	*
14066644	BYPY 6	44"	1 3/8" x 21 Spl. QD	1 3/8" x 21 Spl. QD
14066846	BYPY8	46"	1 3/8" x 21 Spl. QD	1 3/8" x 21 Spl. QD
14107155	W/S 2100	55"	1 3/8" x 6 Spl. QD	30-mm Friction Clutch

* Drivelines are furnished without Cross & Bearing Kit and Implement Yoke. Select kit and yoke as required.

Catfish Pond Driveline

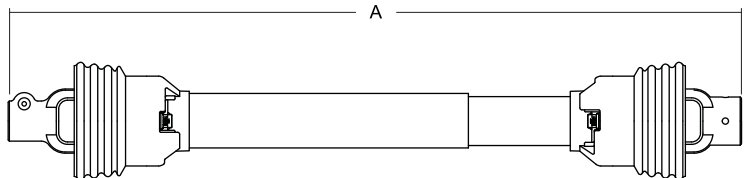

Stock Number	Series	Overall Comp. Length Dim. "A"	Tractor Yoke	Implement Yoke
14006424	BYPY 4	48"	1 3/8" x 6 Spl. QD	1 1/2" Rd
14006524	BYPY 5	48"	1 3/8" x 6 Spl. QD	1 1/2" Rd
14006624	BYPY 6	48"	1 3/8" x 6 Spl. QD	1 1/2" Rd
14016524	BYPY 5	48"	1 3/8" x 21 Spl. QD	1 1/2" Rd
14016624	BYPY 6	48"	1 3/8" x 21 Spl. QD	1 1/2" Rd

Metric Replacement Driveline

Interchanges with Bondioli & Pavesi and Walterscheid

Disc Mower

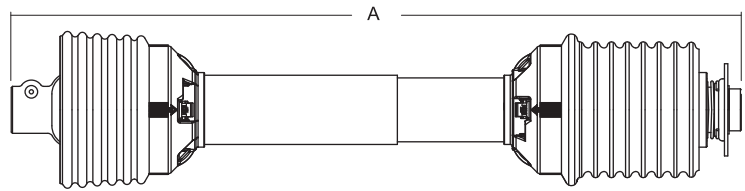

Stock Number	Series	Overall Comp. Length Dim. "A"	Tractor Yoke	Implement Yoke
14306538	BYPY 5	38"	1 3/8" x 6 Spl. QD	1 3/8" x 6 Spl. QD w/Overrunning Clutch
14306639	BYPY 6	39"	1 3/8" x 6 Spl. QD	1 3/8" x 6 Spl. QD w/Overrunning Clutch
14307645	W/S 2400	45"	1 3/8" x 6 Spl. QD	1 3/8" x 6 Spl. QD w/Overrunning Clutch

Fertilizer Spreader

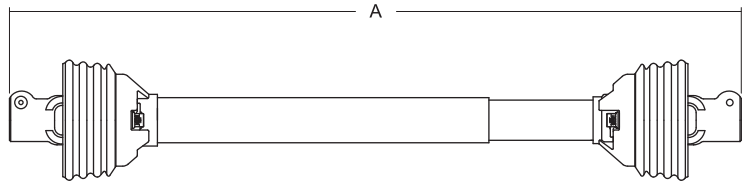

Stock Number	Series	Overall Comp. Length Dim. "A"	Tractor Yoke	Implement Yoke
14006127	BYPY 1	27"	1 3/8" x 6 Spl. QD	1 3/8" x 6 Spl. QD
14006135	BYPY 1	35"	1 3/8" x 6 Spl. QD	1 3/8" x 6 Spl. QD

Finishing Mower

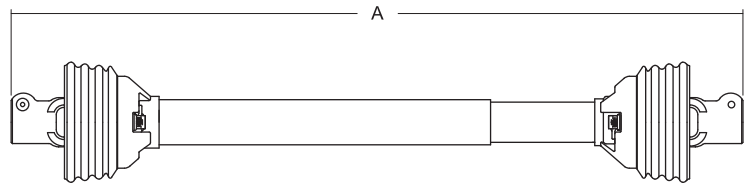

Stock Number	Series	Overall Comp. Length Dim. "A"	Tractor Yoke	Implement Yoke
14006340	BYPY 3	40"	1 3/8" x 6 Spl. QD	1 3/8" x 6 Spl. QD
14006446	BYPY 4	46"	1 3/8" x 6 Spl. QD	1 3/8" x 6 Spl. QD
14006637	BYPY 6	37"	1 3/8" x 6 Spl. QD	1 3/8" x 6 Spl. QD

Hammer Mill

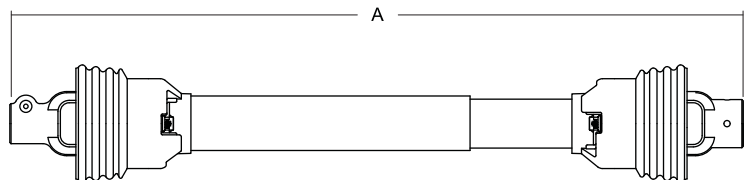

Stock Number	Series	Overall Comp. Length Dim. "A"	Tractor Yoke	Implement Yoke
14006628	BYPY 6	48"	1 3/8" x 6 Spl. QD	1 3/4" Rd.
14006748	BYPY 7	48"	1 3/8" x 6 Spl. QD	1 3/4" Rd.

Hay Tedder

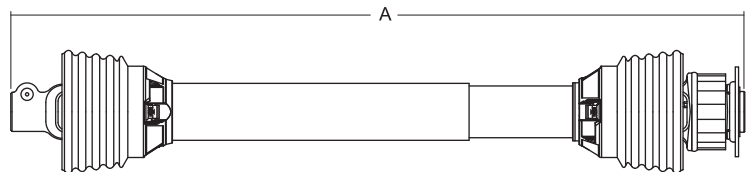

Stock Number	Series	Type	Overall Comp. Length Dim. "A"	Tractor Yoke	Implement Yoke
14206252	BYPY 2*	2-Rotor	52"	1 3/8" x 6 Spl. QD	1 3/8" x 6 Spl. Radial Pin Clutch
14206454	BYPY 4**	4-Rotor	54"	1 3/8" x 6 Spl. QD	1 3/8" x 6 Spl. Radial Pin Clutch

*Light Duty
**Heavy Duty

Metric Replacement Drivelines

Interchanges with Bondioli & Pavesi and Walterscheid

Peanut Harvester Non - CV

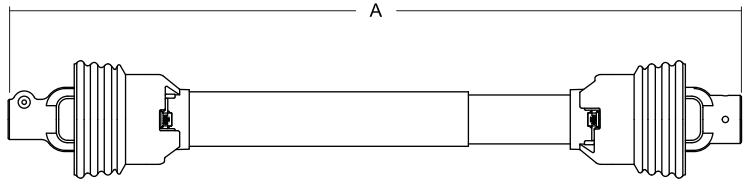

Stock Number	Series	Overall Comp. Length Dim. "A"	Tractor Yoke	Implement Yoke
14007955 (Star)	W/S 2500	55"	1 3/4" x 20 Spl. QD	1 3/8" x 21 Spl. w/Pinhole

Post Hole Digger

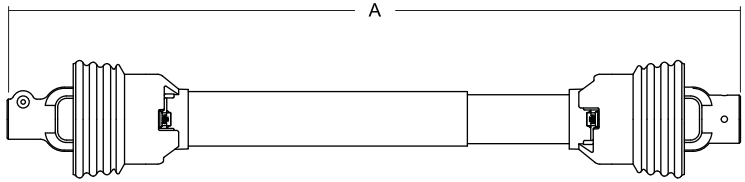

Stock Number	Series	Overall Comp. Length Dim. "A"	Tractor Yoke	Implement Yoke
14006252	BYPY 2 (Light Duty)	52"	1 3/8" x 6 Spl. QD	1 1/4" Rd w/Pinhole
14006453	BYPY 4 (Heavy Duty)	53"	1 3/8" x 6 Spl. QD	1 1/4" Rd w/Pinhole

Rotary Cutter

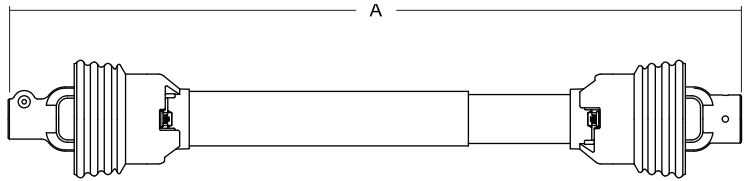

Stock Number	Series	Type	Overall Comp. Length Dim. "A"	Tractor Yoke	Implement Yoke
14006251	BYPY 2	Pull (Towed)	51"	1 3/8" x 6 Spl. QD	1 3/8" Rd w/Pinhole
14006432	BYPY 4	4 ft. Lift (3-pt. Hitch)	32"	1 3/8" x 6 Spl. QD	1 3/8" Rd w/ Pinhole
14006436	BYPY 4	5 ft. Lift (3-pt. Hitch)	36"	1 3/8" x 6 Spl. QD	1 3/8" Rd w/ Pinhole
14006442	BYPY 4	6 ft. Lift (3-pt. Hitch)	42"	1 3/8" x 6 Spl. QD	1 3/8" Rd w/ Pinhole
14006451	BYPY 4	Pull (Towed)	51"	1 3/8" x 6 Spl. QD	1 3/8" Rd w/ Pinhole
14006542	BYPY 5	6 ft. Lift (3-pt. Hitch)	42"	1 3/8" x 6 Spl. QD	1 3/8" Rd w/ Pinhole
14006546	BYPY 5	6 ft. Heavy Duty	46"	1 3/8" x 6 Spl. QD	1 3/8" x 6 Spl. QD
14006551	BYPY 5	6 ft. Lift (3-pt. Hitch)	51"	1 3/8" x 6 Spl. QD	1 3/8" Rd.
14006652	BYPY 6	7 ft. Lift (3-pt. Hitch)	52"	1 3/8" x 6 Spl. QD	1 3/8" Rd w/ Pinhole

Rotary Cutter/Tiller

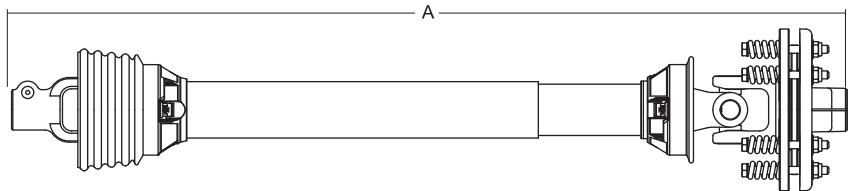

Stock Number	Series	Type	Overall Comp. Length Dim. "A"	Tractor Yoke	Implement Yoke
14106438	BYPY 4	Pull (Towed)	38"	1 3/8" x 6 Sp.I QD	1 3/8" x 6 Spl. w/Friction Clutch
14106546	BYPY 5	Pull (Towed)	46"	1 3/8" x 6 Spl. QD	1 3/8" x 6 Spl. w/Friction Clutch
14106654	BYPY 6	7 ft. Lift (3-pt. Hitch)	54"	1 3/8" x 6 Spl. QD	1 3/8" x 6 Spl. w/Friction Clutch
14106233	BYPY 2	Pull (Towed)	33"	1 3/8" x 6 Spl. QD	1 3/8" x 6 Spl. w/Friction Clutch
14106436	BYPY 4	Pull (Towed)	36"	1 3/8" x 6 Spl. QD	1 3/8" x 6 Spl. w/Friction Clutch
14106660	BYPY 6	7 ft. Lift (3-pt. Hitch)	60"	1 3/8" x 6 Spl. QD	1 3/4" x 20 Spl. w/Friction Clutch
14106661	BYPY 6	7 ft. Lift (3-pt. Hitch)	61"	1 3/4" x 20 Spl. QD	1 3/4" x 20 Spl. w/Friction Clutch

Q.D. Repair Kit

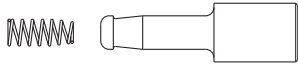

Stock No. 13006121

Repair Kit for 1 3/8" x 6 Spl. & 1 3/8" x 21 Spl.
Bondioli & Pavesi Series 1,2,3,4,5,6,7N, 8 and 9

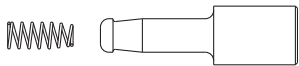

Stock No. 13006720
and
Stock No.: 13006721

Repair Kit for 7N Series
1 3/4" x 20 Spl.

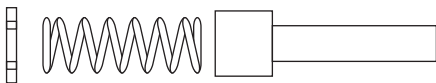

Stock No. 13007120

Repair Kit for 1 3/4" x 20 Spl.
All Walterscheid Series
Spring Internal to Yoke

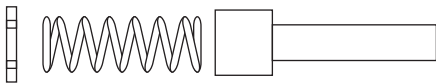

Stock No. 13007138

Repair Kit for 1 3/8" x 6 Spl. & 1 3/8" x 21 Spl.
for all Walterscheid Series

Locking Device Repair Kit

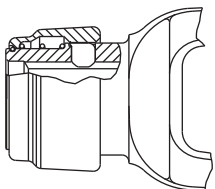

***Auto-Lok/Safety Slide Lock**

Stock No. 13004000

Repair Kit for Weasler Auto-Lok and
Safety Slide Lock
6 Spline & 21 Spline

* This repair kit contains both balls & pawls. When repairing the "Safety Slide Lock" use the pawls only and discard the balls.
When repairing the "Auto-Lok" use both the balls and the pawls.

WORLD WIDE 80° CONSTANT VELOCITY

- LIGHT WEIGHT AND COMPACT DESIGN FOR HANDLING EASE
- METRIC NOW HAS SEALED CENTER HOUSING WITH NORTH AMERICAN-STYLE BALL AND SOCKET SYSTEM



**N.A. Equal Arm
80° C.V. Joint**

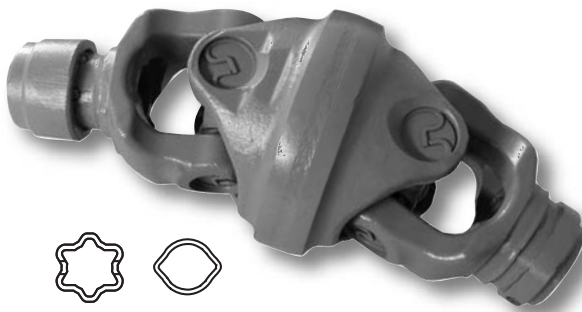

**Metric Equal Arm
80° C.V. Joint**



**80° Equal Arm
Tractor Yokes**



**Bushing Lube
Cross Kits**



Easy Lock Guarding



**Metric
Old-Style**

**Metric & Domestic
New-Style**

- SINGLE GUARD POSITION WILL ACCESS ALL GREASE ZERK LOCATIONS ON C.V.
- GUARD SYSTEMS ARE CE AND ISO COMPLIANT
- ARTICULATED GUARD SYSTEM PROVIDES FULL COVERAGE AT MAXIMUM ANGLE
- METRIC GUARD IS NOW UPGRADED TO THE PATENTED NORTH AMERICAN AND USER-FRIENDLY EASY LOCK SYSTEM

Higher Value - Smarter Solutions